

# debbie fortune

ESTATE AGENTS

## Southlands Way, Congresbury

£220,000

🛏 1 🚿 1 🚗 1



A well designed and compact, yet convenient, semi-detached home, situated in Congresbury. Offering easy links into Bristol, Bath and the M5 junctions. EPC rating C.



## Key Features

- Semi Detached House
- One Bedroom
- Walking distance to a range of local amenities
- Private driveway for one car
- Convenient links into Bristol via, M5, A38 or neighbouring train station
- Ideal investment property, close to Langford Veterinary School
- Open Plan Living
- Council Tax band B
- Garden Area
- Viewing Advised

GROUND FLOOR

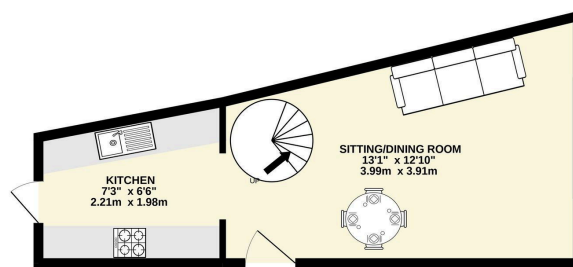

1ST FLOOR

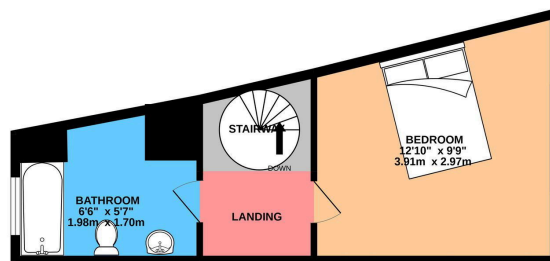

Whilst every attempt has been made to ensure the accuracy of the floorplan contained here, measurements of doors, windows, rooms and any other items are approximate and no responsibility is taken for any error, omission or mis-statement. This plan is for illustrative purposes only and should be used as such by any prospective purchaser. The services, systems and appliances shown have not been tested and no guarantee as to their operability or efficiency can be given.  
Made with Metropix (©2022)

