



Richmont Place, East Harptree

Offers Over £835,000

 4  2  2



An exceptional four bedroom contemporary house set in a quiet and exclusive cul-de-sac in East Harptree. This truly impressive home has a superb design led interior with a host of magnificent upgrades and bespoke features.



Key Features

- Exceptional four bedroom detached modern house
- Large double garage with electric up and over doors
- Exceptional open plan kitchen, diner, family room
- Bright, light and spacious throughout
- Owner Solar Panels
- Superb eco-credentials with a B rated EPC.
- Beautiful designer interior and landscaped garden
- Separate drawing/family room
- Well appointed utility room
- Four bedrooms (master en-suite) plus chic family bathroom and cloakroom

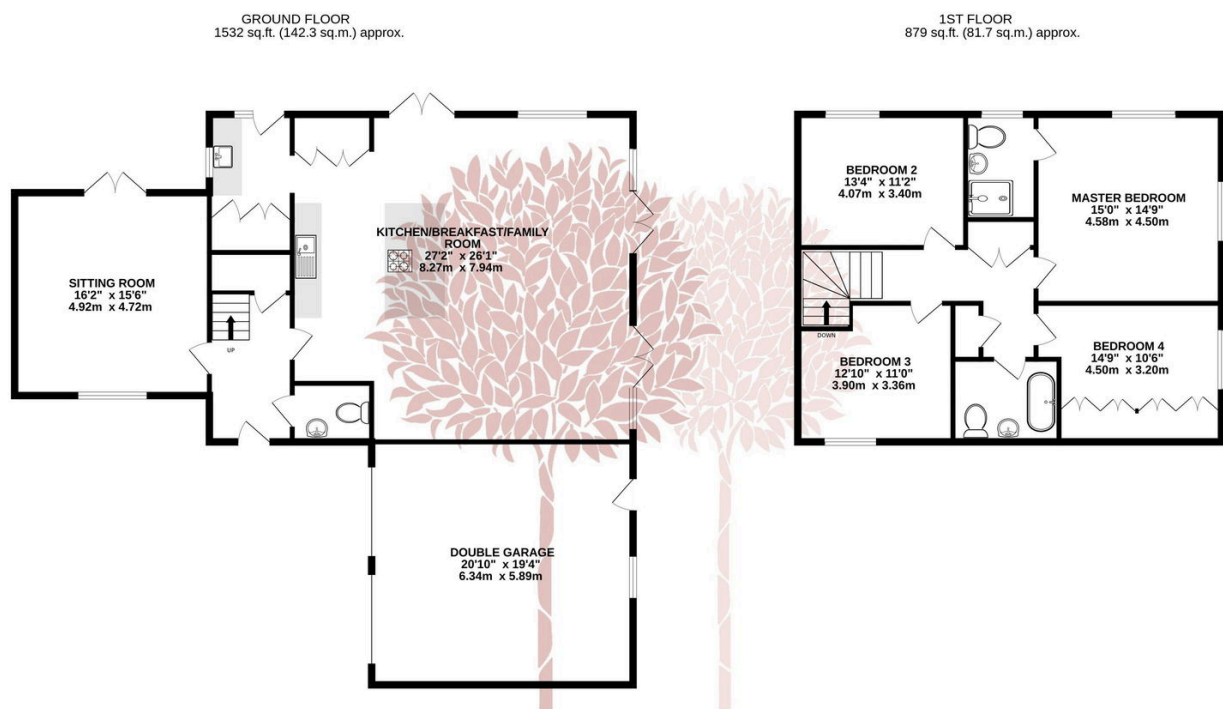

GROUND FLOOR
1532 sq.ft. (142.3 sq.m.) approx.

1ST FLOOR
879 sq.ft. (81.7 sq.m.) approx.

TOTAL FLOOR AREA: 2411 sq.ft. (223.9 sq.m.) approx.

Whilst every attempt has been made to ensure the accuracy of the floorplan contained here, measurements of doors, windows, rooms and any other items are approximate and no responsibility is taken for any error, omission or mis-statement. This plan is for illustrative purposes only and should be used as such by any prospective purchaser. The services, systems and appliances shown have not been tested and no guarantee as to their operability or efficiency can be given.
Made with Metropix ©2024

