

Ashleigh Crescent, Yatton

Guide Price £530,000

🛏 4 🚿 2 🛋 2



- Detached and remodelled family home
- South Facing Garden
- Backwell School catchment area
- New windows fitted in 2020
- Set in glorious south facing gardens with well stocked trees, shrubs and pond
- Four well-proportioned bedrooms
- Garden room with bi-fold doors
- Open plan kitchen/breakfast room
- Walking distance to all village amenities, strawberry line and train station
- Garden office

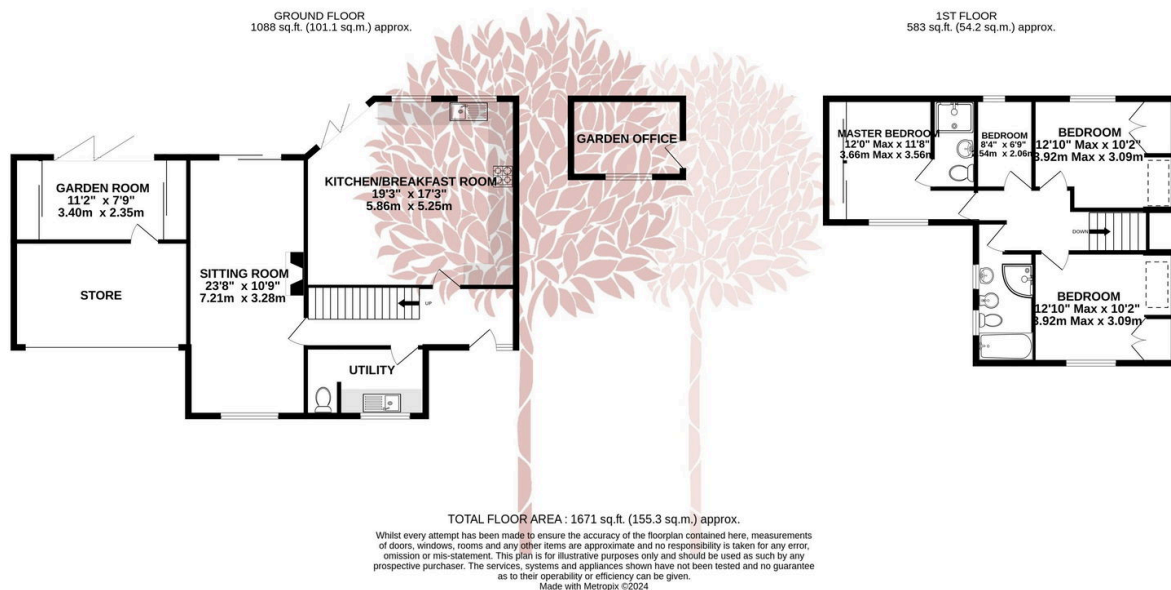

STUNNING INTERIOR & GARDENS - An extended detached family home offering lots of accommodation, stunning interior and well-stocked gardens set in the popular village of Yatton. Close to Cadbury Spa and Leisure Centre and one min access to train station and the Strawberry Line cycle route.

