



Church Road, Dundry

£599,950

 4  2  3

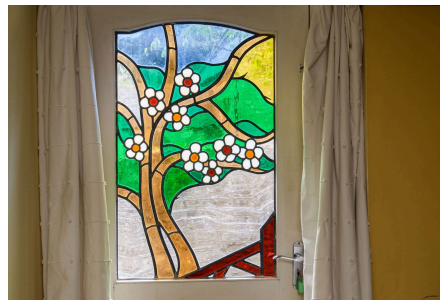

A handsome three storey period house occupying a delightful village position in the popular village of Dundry. Offering versatile accommodation, the property offers four/five bedrooms, three reception rooms, two bathrooms, kitchen/breakfast room and an integrated garage. There is a lovely private garden, off street parking and lots of original period features.



Key Features

- Handsome three storey period home
- Lovely central village location close to the school, church and village hall
- Four bedrooms, plus potential fifth ground floor bedroom with Bi-folding doors
- Gated off street parking plus integral garage
- Two beautiful adjoining reception rooms with feature fireplaces
- Characterful Kitchen/breakfast room
- Two well appointed bathrooms
- Private garden enclosed by stone walls with lawn and brick paved patio
- Lovely period features including fireplaces, stone floors, exposed beams and exposed stone walls

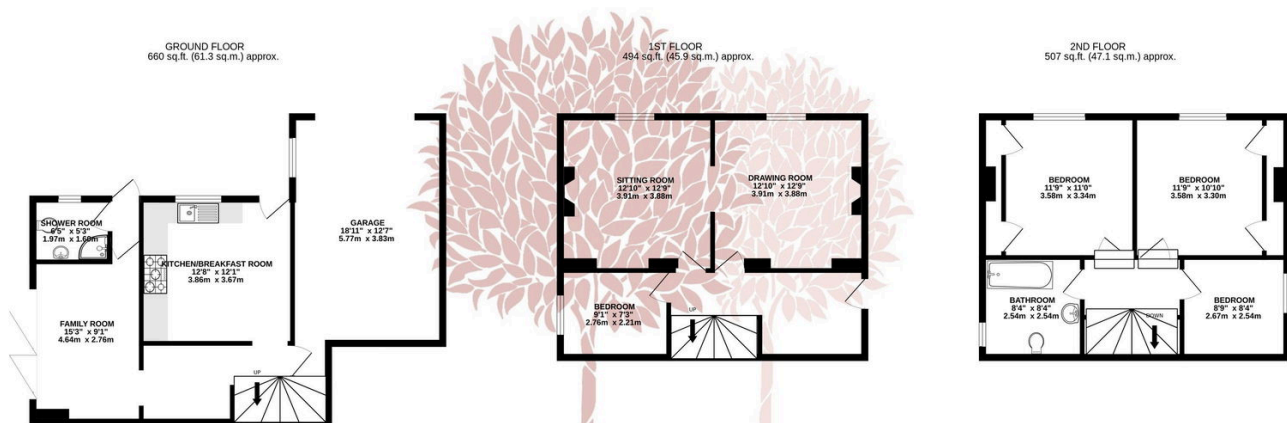

TOTAL FLOOR AREA: 1661 sq.ft. (154.3 sq.m.) approx.

Whilst every attempt has been made to ensure the accuracy of the floorplan contained here, measurements of doors, windows, rooms and any other items are approximate and no responsibility is taken for any error, omission or mis-statement. This plan is for illustrative purposes only and should be used as such by any prospective purchaser. The services, systems and appliances shown have not been tested and no guarantee as to their operability or efficiency can be given.
Made with Metropix 6/2024.

