

Mendip Road, Yatton

£465,000

3 2 1

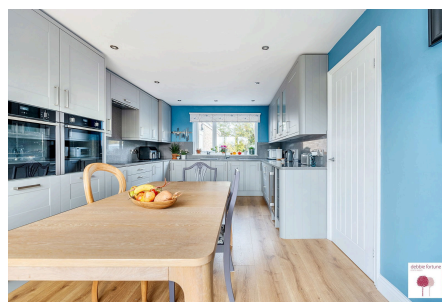

A beautifully presented three bedroom detached modern home situated in a delightful position with a southerly facing landscaped garden with glorious open views, a stylish design led interior, generous off street parking and a single garage



Key Features

- Beautifully presented detached family home
- Master bedroom with walk in dressing room and en-suite shower room
- Dual aspect sitting room with French doors to the rear
- Outstanding south facing landscaped garden with superb views
- Owned Solar Panels
- Three bedrooms (formerly four)
- Stunning designer kitchen with numerous integrated appliances
- Ground floor cloakroom and utility room
- Generous off street parking plus single garage.
- EPC rating B, Council Tax Band D

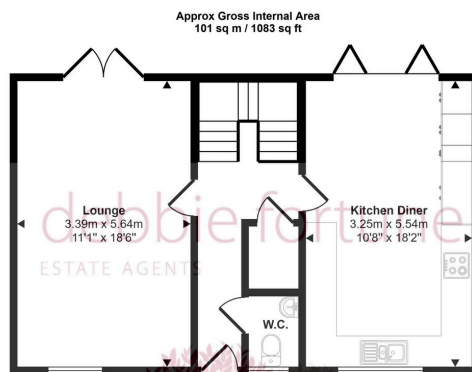

Ground Floor
Approx 50 sq m / 538 sq ft

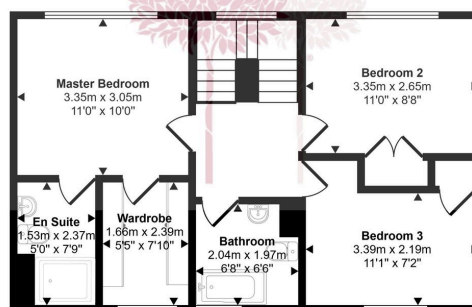

First Floor
Approx 51 sq m / 544 sq ft

This floorplan is only for illustrative purposes and is not to scale. Measurements of rooms, doors, windows, and any items are approximate and no responsibility is taken for any error, omission or mis-statement. Icons of items such as bathroom suites are representations only and may not look like the real items. Made with Made Snappy 360.

