

## Capri Villas, Kewstoke Road

£240,000

🛏 2 🚗 1 🚗 1



**NO ONWARD CHAIN - A two bedroom apartment situated on the edge of the town with spectacular coastal views. The property is offered with with off street parking and garage.**



## Key Features

- Two bedroom apartment
- Potential to improve
- Large L-shaped sitting/dining room
- Communal grounds
- Council tax band C
- Superb coastal views
- No onward chain
- Off street parking and garage
- EPC rating D
- 

GROUND FLOOR  
921 sq.ft. (85.5 sq.m.) approx.

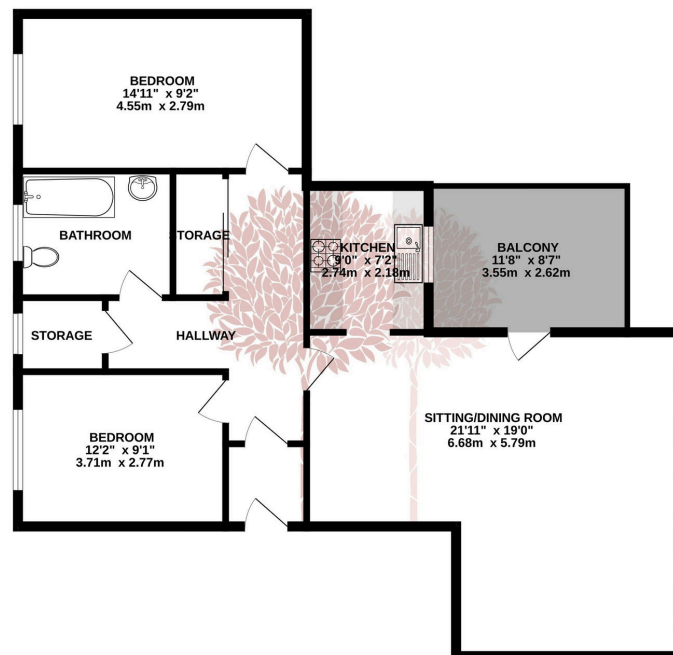

TOTAL FLOOR AREA : 921 sq.ft. (85.5 sq.m.) approx.

Whilst every attempt has been made to ensure the accuracy of the floorplan contained here, measurements of doors, windows, rooms and any other items are approximate and no responsibility is taken for any error, omission or mis-statement. This plan is for illustrative purposes only and should be used as such by any prospective purchaser. The services, systems and appliances shown have not been tested and no guarantee as to their operability or efficiency can be given.  
Made with Metropix ©2024

