



RAPHAEL AGBANDJE POWERED BY **exp** TM UK

@ raphael.agbandje@exp.uk.com

🌐 raphaelagbandje.exp.uk.com

☎ 0203 488 5876



## Fajr House, 126 Eltham Road, Eltham, London SE9 5LS

Offers Over £325,000

🛏️ 2 🚿 1 🛋️ 1

- Chain Free
- Two Double Bedrooms
- Recently fitted stylish Kitchen
- Contemporary Decor throughout
- Dual Aspect Reception room
- Moments from Sutcliffe Park
- Kidbrooke, Lee and Eltham Stations nearby
- Close to Transport and Amenities



This contemporary 2-bedroom apartment presents an excellent chance to step into the property market. Ideally located near both Lee and Kidbrooke rail stations, this purpose-built residence offers approximately 700 sq ft of thoughtfully organised space.

The open-plan living area, enhanced by large windows, is filled with natural light, creating an inviting and spacious atmosphere. The recently updated kitchen features ample countertop space and dedicated areas for all essential appliances, perfectly catering to modern lifestyles.

The apartment includes two generously sized bedrooms, extensive storage, and a sleek, modern bathroom.





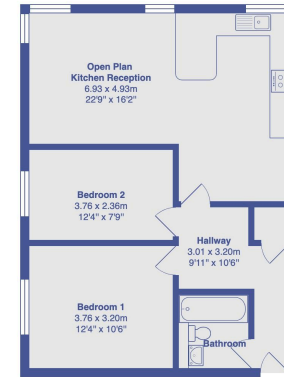

Fajr House, 126, Eltham Road, Eltham, SE9 5LS  
 Total Area: 64.5 m<sup>2</sup> ... 694 ft<sup>2</sup>  
 All measurements are approximate and for display purposes only

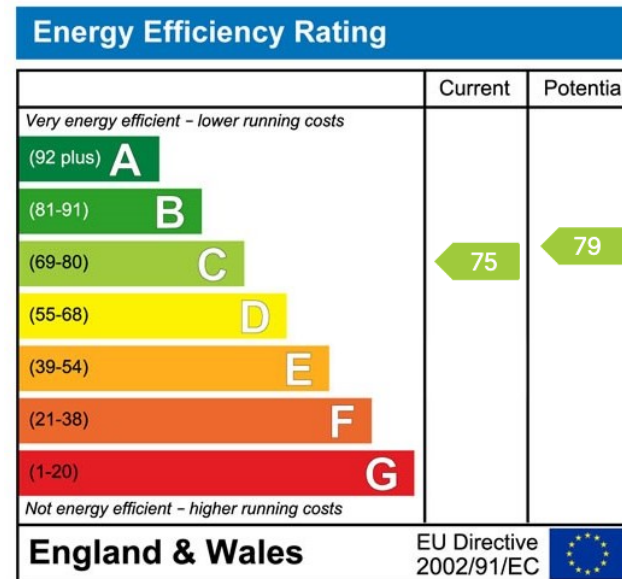

eXp World UK Ltd is a registered company at Level 37, 25 Canada Square, London, E14 5LQ.

Registered company number is 12016573. VAT Registration Number is 327 4120 29