

Denham Corner, Denham, Eye

Guide Price £240,000 - £260,000

🛏️ 2 🚿 1 🚗 1



Boasting a prime position and an extremely rare opportunity, this two bedroom chalet enjoys stunning rural views over the countryside. Further benefitting from a double garage, southerly facing rear gardens and no onward chain.

Key Features

- ****Guide Price £240,000 - £260,000****
- Field views
- Rural location
- Conservatory
- Southerly facing rear gardens
- No onward chain
- Freehold
- Council Tax Band A
- Double garage
- Mains water

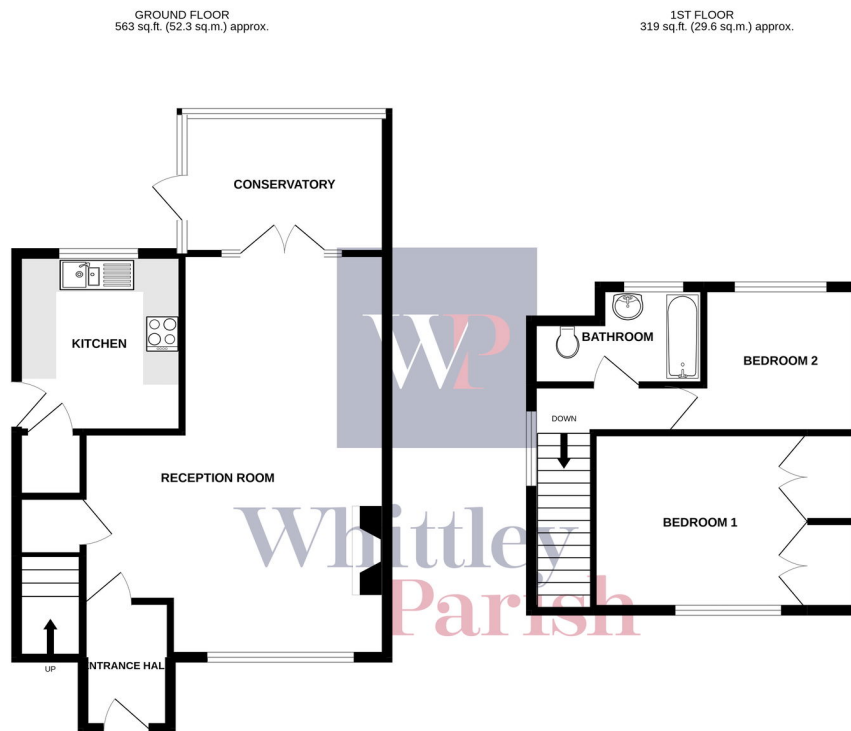

TOTAL FLOOR AREA - 882 sq.ft. (81.9 sq.m.) approx.

Whilst every attempt has been made to ensure the accuracy of the floorplan contained here, measurements of doors, windows, rooms and any other items are approximate and no responsibility is taken for any error, omission or mis-statement. This plan is for illustrative purposes only and should be used as such by any prospective purchaser. The services, systems and appliances shown have not been tested and no guarantee as to their operability or efficiency can be given.
Made with Metrepro ©2022