



# Dowling Drive, Fradley, Lichfield

Offers Over £400,000

4 2 1



A fantastic opportunity to acquire a consistently beautifully presented four bedroom family home in a sought after location. This impressive detached property on Dowling Drive sits within the in-demand village of Fradley and comes to the market with an extensive range of attractive features, from the contemporary and dual aspect kitchen/diner with utility off, to the stunning and very versatile home bar courtesy of a wonderful garage conversion.

Fradley is always very popular and is only becoming more and more so, with a wide range of amenities easily accessible, including gyms, eateries, scenic walks and the availability of a short drive to Lichfield and other areas via the A38.

The accommodation is set across three floors, with an entrance hall, living room, kitchen/diner, utility and guest WC all to the ground floor, whilst the first two of four double bedrooms (dual aspect Master bedroom with attractive en-suite) and main bathroom occupy the first floor and two further excellent size double bedrooms sit to the second. A charming frontage, spacious double length driveway and private rear garden make up the property's exterior.

This property really does offer fantastic value for money when factoring in four truly generous double bedrooms, all-round stunning presentation and a desirable location, so we must advise booking in a viewing at your earliest convenience.



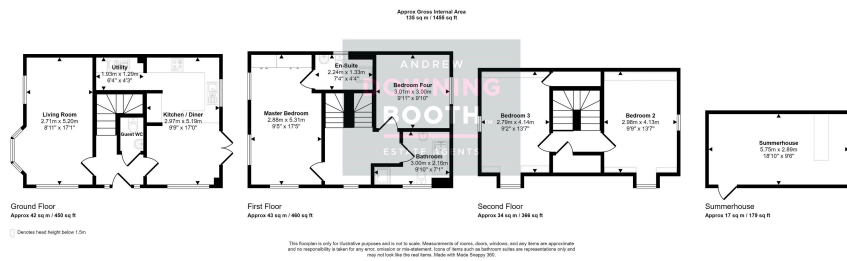

- Four Double Bedroom Detached Property
- Double Length Driveway
- Beautifully Presented Throughout
- Home Bar / Summerhouse
- EPC Rating: B
- Highly Desirable Location
- Stunning & Contemporary Kitchen/Diner
- Fabulous Dual Aspect Master Bedroom With En-Suite
- Generous Room Sizes Throughout
- Council Tax Band: E

