



ANDREW
DOWNING
BOOTH™
ESTATE AGENTS

Complete Four Bedroom Family Home - The Leasow, Hill Ridware

£550,000

🛏️ 4 🚿 2 🚗 2



A simply magnificent and substantial four double bedroom family home, presented to a truly superb standard throughout and located in the highly desirable and semi-rural village of Hill Ridware.

Location-wise, Hill Ridware is one of Staffordshire's most sought after villages, thanks to its quaint nature, community spirit and endless surrounding countryside, whilst even offering a recently introduced bus service to neighbouring areas.

The accommodation is set across two floors, with a spectacular and triple aspect open-plan kitchen/lounge/diner, separate dual aspect and very large living room, utility and guest WC all to the ground floor, whilst the first floor is home to all four double bedrooms and the stunning main bathroom, with the Master suite boasting extensive built in wardrobes and en-suite shower room, whilst the second bedroom also comes with its own contemporary en-suite. A particularly charming frontage and attractive frontal outlook are complimented by a more-than-ample driveway, detached double garage and beautifully landscaped rear garden that even features a fully equipped summerhouse, offering an abundance of potential uses, to make up the property's exterior.

To say that this incredible residence is the complete family home would be absolutely no exaggeration; viewing in person is the only way to truly appreciate just how much is on offer.



ANDREW
DOWNING
BOOTH
ESTATE AGENTS



ANDREW
DOWNING
BOOTH
ESTATE AGENTS

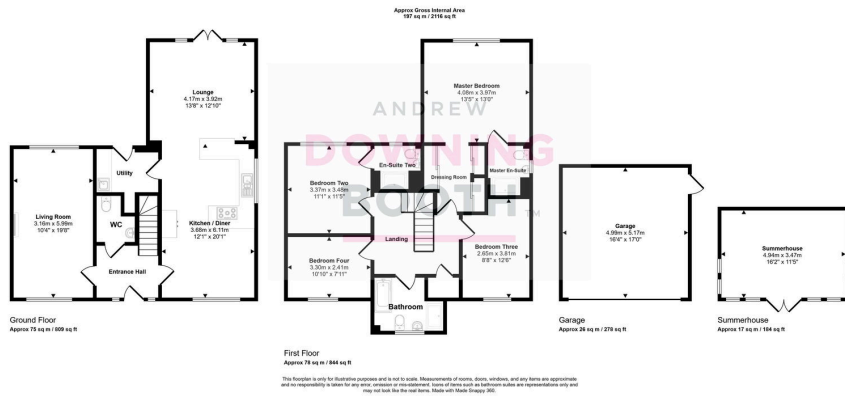

- Substantial Four Double Bedroom Detached Family Home
- Highly Desirable Semi-Rural Village Location
- Master Bedroom & Bedroom Two Each With Contemporary En-Suite
- Private Rear Garden, Multi-Vehicle Driveway & Very Large Garage
- EPC Rating: B
- Beautifully Finished & Impeccably Presented Throughout
- Consistently Impressive Room Sizes Across Both Floors
- Attractive Outlook Over Neighbouring Green
- Magnificent Open Plan Kitchen / Lounge / Diner With Utility
- Council Tax Band: F

