



Your Logo

WOODLAND CLOSE, Pedmore, Stourbridge, DY9 0TQ

Offers In Region Of £295,000

🛏 2 🚿 1 🚗 1

- Prime cul-de-sac setting within Pedmore.
- Well cared for over the years, now looking for its next chapter.
- Modern Kitchen, Conservatory.
- Having NO UPWARD CHAIN, an early viewing is advised.
- A two bedroom Semi Detached Bungalow.
- Porch, Entrance Hall, Bathroom, good sized Living Room.
- Large Rear Garden, Garage, Off road parking.
- EPC Rating TBC.



Occupying this prime PEDMORE ADDRESS, this well cared for TWO BEDROOM SEMI DETACHED BUNGALOW is looking for its next chapter. Pleasantly situated within the cul-de-sac, the Bungalow offers living accommodation to include Two Bedrooms, both with useful fitted wardrobes, a good sized Living Room, Modern Kitchen, Conservatory and a Bathroom. To the Rear is a LARGE GARDEN. The Bungalow further benefits from off road parking and a Garage. Having NO UPWARD CHAIN, an early viewing is advised. Contact Jeremy Rhead to arrange a viewing.



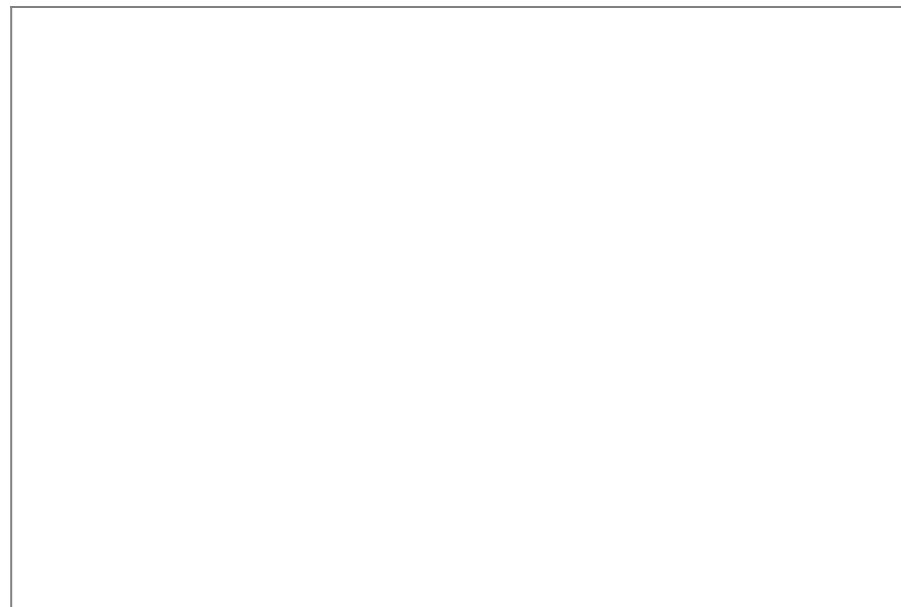
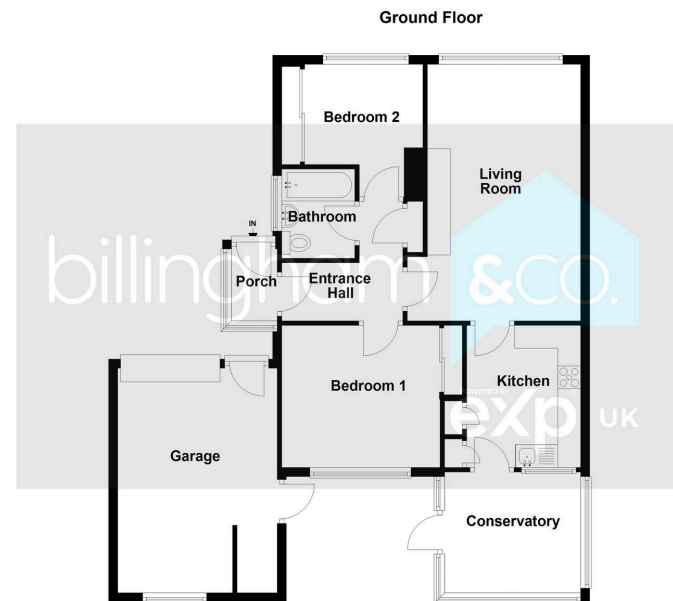

Sales 01384 444 004 / Lettings 01384 445 075
 hello@billingham.properties
 www.billingham.properties



Agents Note: Whilst every care has been taken to prepare these particulars, they are for guidance purposes only. All measurements are approximate and are for general guidance purposes only and whilst every care has been taken to ensure their accuracy, they should not be relied upon and potential buyers are advised to recheck the measurements.