

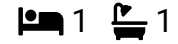

SIGNATURE
PROPERTY PARTNERS

Vicarage Road, Leyton

Guide Price £325,000 - £375,000



Step into this substantial Victorian flat, located in a grand townhouse in the heart of Leyton. Boasting one spacious bedroom, a bright and airy lounge, and a well-maintained kitchen, this flat is a perfect blend of classic charm and contemporary living. With its soaring ceilings, intricate period detailing, and iconic Victorian features. Complete with share of freehold and no service or ground rent costs. Local Vibes & Lifestyle Situated just moments from Leyton High Road and the ever-popular Francis Road, you'll find yourself immersed in a vibrant East London community. Francis Road, a buzzing hub of independent shops, trendy cafes, and boutique stores, has transformed into a destination for creatives and professionals alike. It's the perfect spot for young professionals, creatives, or anyone looking to experience the unique East London vibe. This home won't stay on the market for long—book your viewing today! Ref: DM008



Floor Area: sq. ft.

Tenure: Share Of Freehold

Service Charge: £0 per annum

Ground Rent: £0 per annum

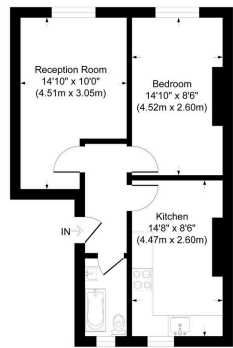

First Floor



Vicarage Road

Approximate Gross Internal Area
Total = 45.2 sq m / 487 sq ft

This plan is for general guidance only. Not drawn to scale unless stated. Windows and door coverings are approximate. Whilst every care is taken in the preparation of this plan, please check all dimensions, shapes and compass bearings before making any decisions reliant upon them.

presented by
THE360IMAGE
www.the360image.co.uk



INFO@SIGNATUREPROPERTYPARTNERS.CO.UK

WWW.SIGNATUREPROPERTYPARTNERS.CO.UK