



12 Wilkes Street, Oldham

£199,950

🛏️ 3 🚿 1 🛋️ 2



- 1938 Semi Detached House
- Three Bedrooms
- Elevated location
- Two Reception Rooms
- No Chain
- Private Rear garden
- Close To Quality Schools
- EPC: E



Offered for sale is this lovely honest three bedroom 1938 bay fronted family semi detached home located in Moorside.

Accommodation comprising: Entrance porch, good size hallway, living room, dining room, kitchen and a small conservatory.

To the first floor there are three bedrooms, two double and a single. Separate W.C and a bathroom.

Externally there is a private rear garden, front garden with steps and on road parking. Local junior school across the road.

Amenities within easy reach. Contact us today to arrange an appointment to view.

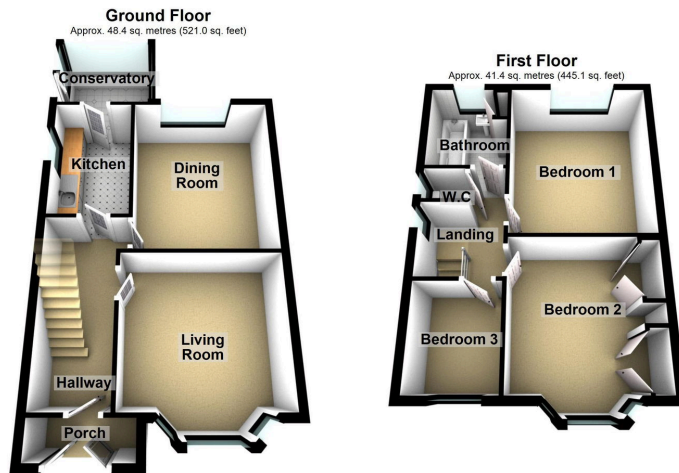

Total area: approx. 89.8 sq. metres (966.1 sq. feet)

Energy Efficiency Rating		
	Current	Potential
Very energy efficient - lower running costs		
(92 plus) A		
(81-91) B		81
(69-80) C		
(55-68) D		
(39-54) E	49	
(21-38) F		
(1-20) G		
Not energy efficient - higher running costs		
England & Wales	EU Directive 2002/91/EC	

Chadderton Office

509 Middleton Road,
Chadderton, Oldham,
OL9 9SH

chadderton@kirkham-property.co.uk
t: 0161 626 5688