



14 Hayle Road, Oldham, OL1 4NW

£194,950

🛏 3 🚿 1 🛋 2

- No Chain
- Three Bedrooms
- Good Area
- Driveway
- Semi Detached
- Two Reception Rooms
- Private Rear Garden
- EPC:



NO CHAIN. Offered for sale is this three bedroom semi detached family home located in Moorside.

Accommodation comprising: Entrance hallway, lounge, dining area and a kitchen.

To the first floor there are three bedrooms and a bathroom.

Externally is a private rear garden and a driveway to the front.

Tucked away in a small cul de sac with searching views to the front.

Contact us today to arrange a viewing.



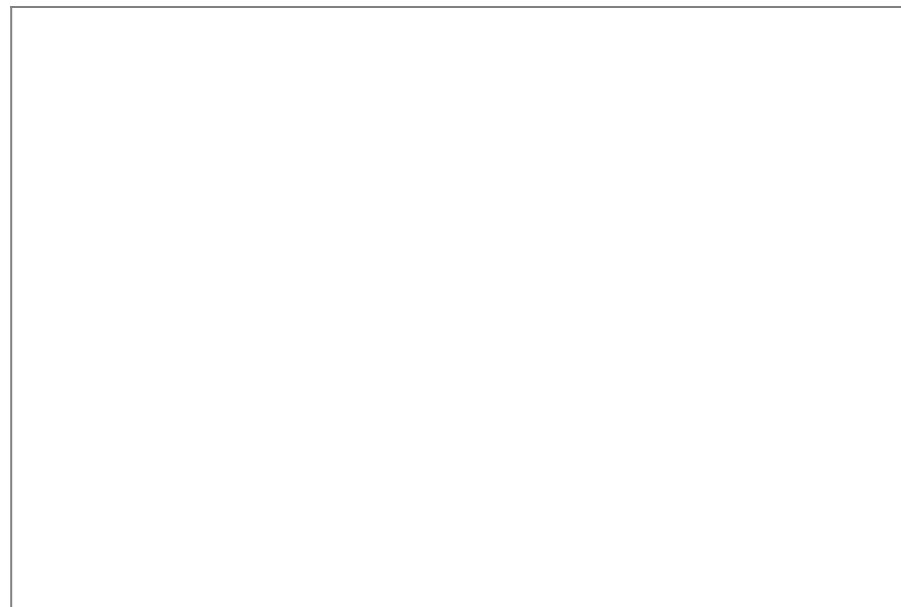
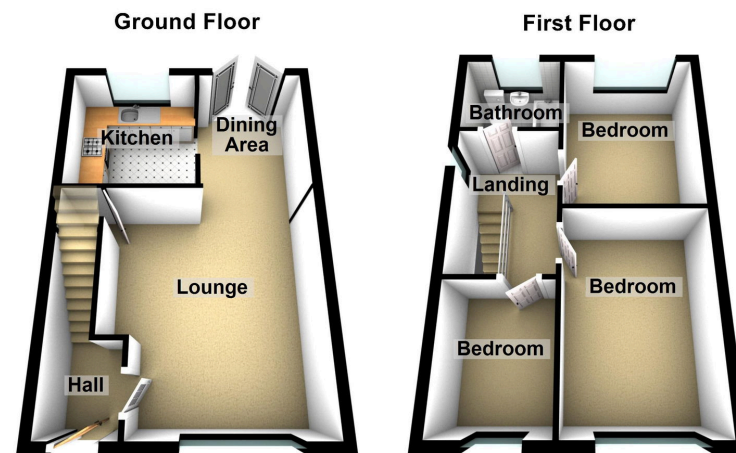

Chadderton Office

509 Middleton Road,
Chadderton, Oldham,
OL9 9SH

chadderton@kirkham-property.co.uk
t: 0161 626 5688