



140 Boundary Park Road, Oldham, OL1 2NZ

£180,000

🛏️ 2 🚿 1 🛋️ 2



- Great Location
- Good Size Bay Fronted Terraced Property
- Spacious Kitchen/Dining Room
- Two good Size Bedrooms
- Bathroom
- uPVC Windows
- Rear Yard
- EPC: C



Offered for sale is this lovely two bedroom bay fronted mid terraced property located in this popular spot.

Accommodation comprising: Entrance vestibule, lounge, kitchen/dining room and a conservatory.

To the first floor there are two good size bedrooms and a bathroom.

Rear yard with access and garden fronted.

Close to Royton centre and motorway networks.

Contact us today to arrange a viewing.

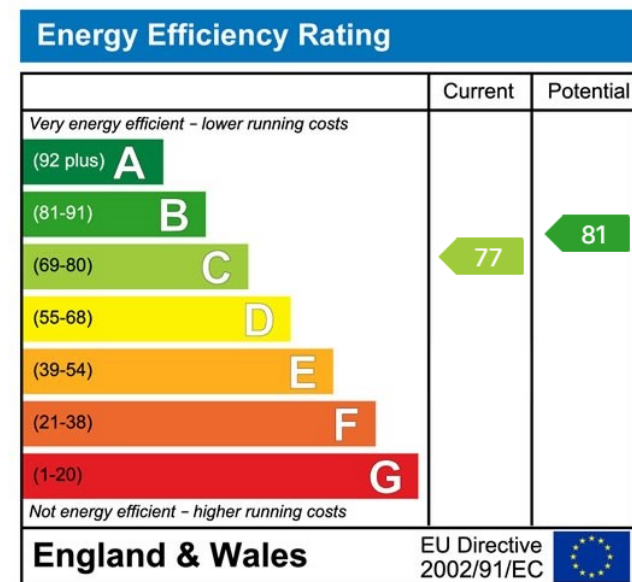
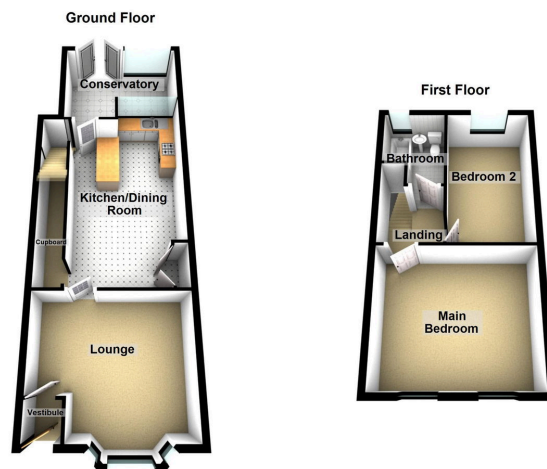

Chadderton Office

509 Middleton Road,
Chadderton, Oldham,
OL9 9SH

chadderton@kirkham-property.co.uk
t: 0161 626 5688