



Windsor Court, Catsey Lane, Bushey, WD23 4HY

£1,600PCM (Deposit: £1,846)

 2  1  1



Tax Band: C Furnished:
Unfurnished

- Unfurnished flat
- Two double bedrooms
- Modern kitchen and bathroom
- Gas central heating
- Recently decorated
- Ground floor
- Large living room
- Entryphone system
- on street parking
- Close to local shops and park

GROUND FLOOR
758 sq.ft. (70.4 sq.m.) approx.

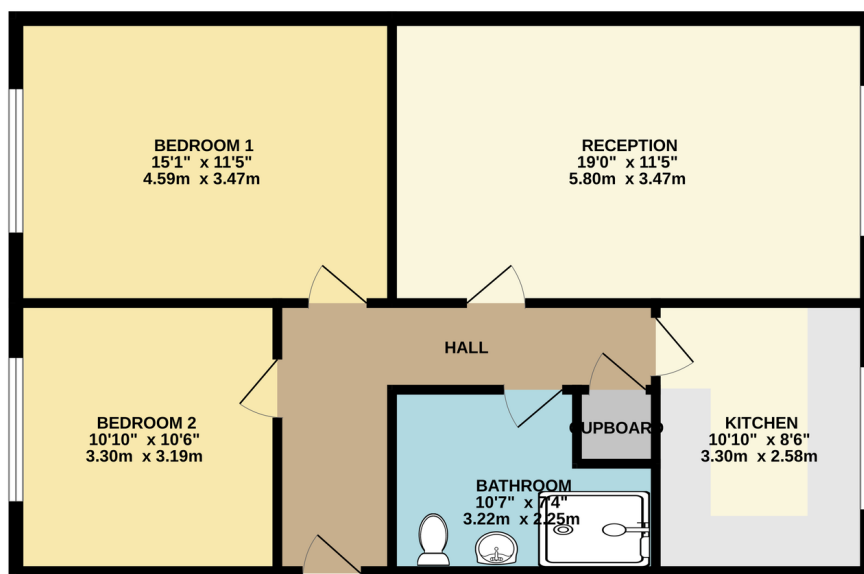

TOTAL FLOOR AREA : 758 sq.ft. (70.4 sq.m.) approx.

Whilst every attempt has been made to ensure the accuracy of the floorplan contained here, measurements of doors, windows, rooms and any other items are approximate and no responsibility is taken for any error, omission or mis-statement. This plan is for illustrative purposes only and should be used as such by any prospective purchaser. The services, systems and appliances shown have not been tested and no guarantee as to their operability or efficiency can be given.
Made with Metropix ©2025

A recently decorated two bedroom ground floor unfurnished flat, available immediately to rent. Located close to local shops, King George Recreation Ground, Bushey Heath and Bushey Village, various schools and with the nearest station at Bushey Station. The property comes with modern kitchen and shower room / wc, communal gardens, on street parking, entryphone system and gas central heating. Council Tax band : C, Hertmere Borough Council. EPC Rating: C.