



14 Rocklands Drive

£2,300PCM (Deposit: £2,653)

 3  1  1



Tax Band: E
Furnished:
Not furnished

- Unfurnished
- Three bedrooms
- Through lounge
- Kitchen
- Family bathroom / wc
- Off street parking to front
- 100' rear garden
- Available now
-
-

GROUND FLOOR
432 sq.ft. (40.1 sq.m.) approx.

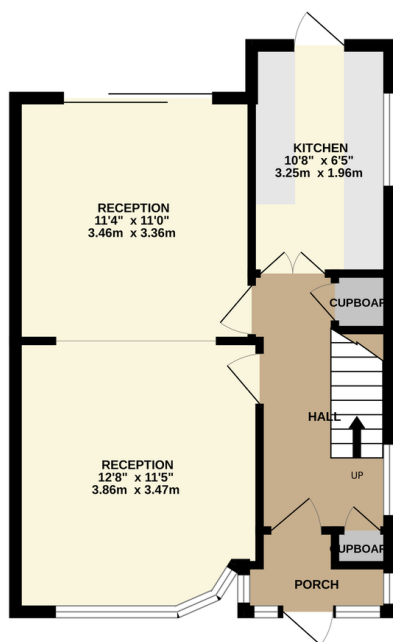

1ST FLOOR
410 sq.ft. (38.1 sq.m.) approx.

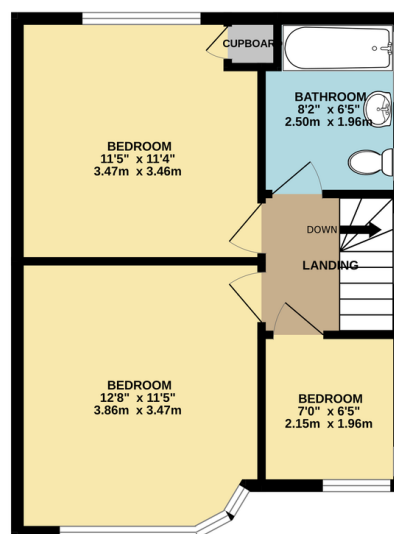

TOTAL FLOOR AREA: 842 sq.ft. (78.3 sq.m.) approx.

Whilst every attempt has been made to ensure the accuracy of the floorplan contained here, measurements of doors, windows, rooms and any other items are approximate and no responsibility is taken for any error, omission or mis-statement. This plan is for illustrative purposes only and should be used as such by any prospective purchaser. The services, systems and appliances shown have not been tested and no guarantee as to their operability or efficiency can be given.
Made with Metropix ©2024

An unfurnished and well presented three bedroom semi-detached house with a large through lounge, kitchen, family bathroom / wc, detached garage, off street parking to front and approx 100' south facing rear garden. Available immediately. With convenient access to Priestmead and Park High Schools, Belmont Circle for shops and bus routes to Harrow, Queensbury, Kenton, Stanmore. North London Collegiate for girls and Haberdashers Aske for boys and girls are within a short drive away. EPC Rating: D. Council Tax Band: E.