

Your Logo

Mereside, Portland, DT5 1FU

£1,350PCM (Deposit: £1,557)

0 1 1

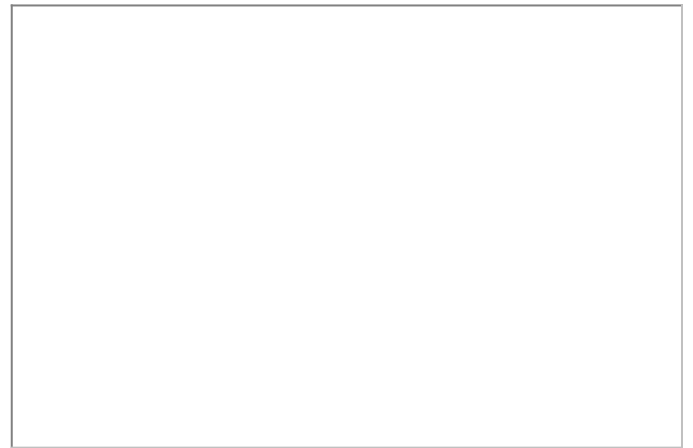

Tax Band: Furnished: Not specified

AVAILABLE EARLY NOVEMBER

Commercial/Light Industrial unit benefitting allocated parking on site with a second floor Mezzanine Deck.

Your Logo

- Disabled WC With H&C
- Three Phase Electricity
- Fire Alarm
- Kitchen With Sink and H&C
- Reception Office
- Hi - Bay LED Lights
- Smoke Detectors
- On Site Parking

Approx Gross Internal Area
166 sq m / 1790 sq ft

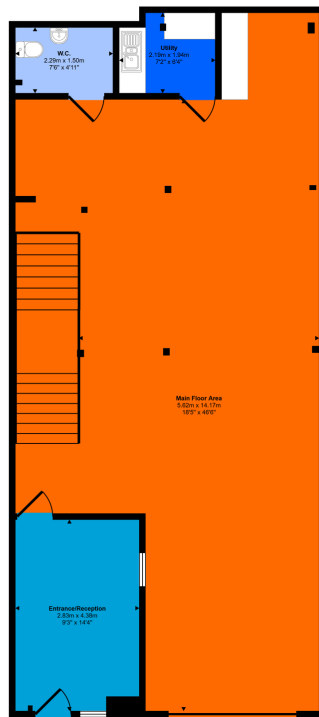

Ground Floor
Approx 111 sq m / 1198 sq ft

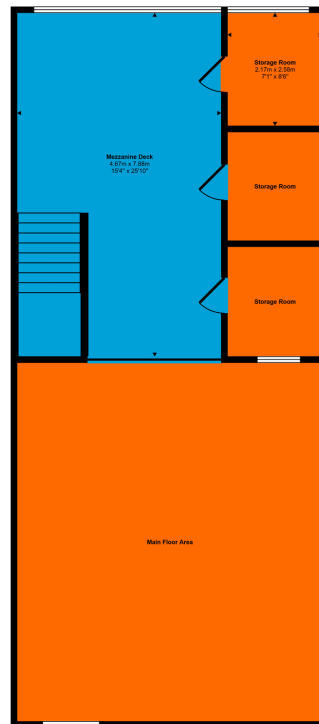

First Floor
Approx 85 sq m / 913 sq ft

This floorplan is only for illustrative purposes and is not to scale. Measurements of rooms, doors, windows, and any items are approximate and no responsibility is taken for any error, omission or mis-statement. Icons of items such as bathroom suites are representations only and may not look like the real items. Made with Made Snappy 360.