



Loporto Browne
— RESIDENTIAL —

Graham Road, NW4

£1,950PCM (Deposit: £2,250)

🛏️ 2 🚿 1 🚗 1



- Garden apartment
- Off-street parking
- Furnished or unfurnished
- Large communal garden
- B energy rating
- Set within a stylish modern development
- Bike shed
- Close to transport
- Underground and train station within walking distance
- Close to shops

Tax Band: D Furnished: Furnished optional

This beautifully presented garden apartment is set within a stylish, modern development in the sought-after NW4 area. The property benefits from direct access to a large communal garden, off-street parking and bike and storage shed.

Can be furnished or unfurnished.

This property is perfect for professionals, couples, or small families looking for a contemporary home in a convenient residential location.

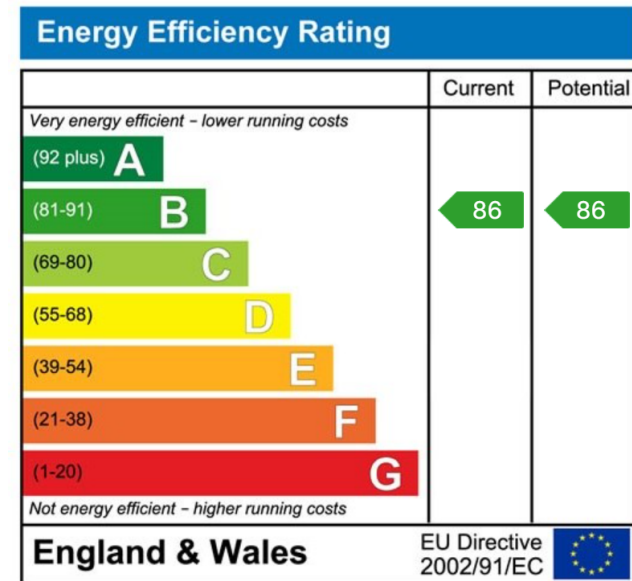
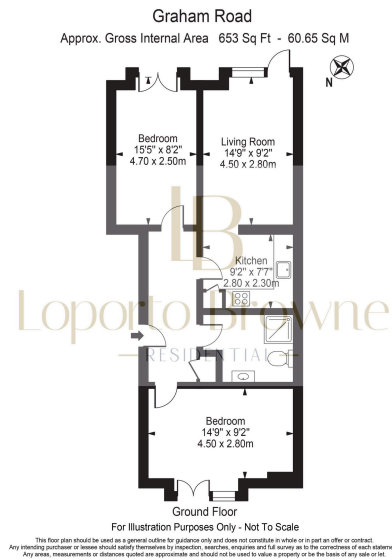

LB Residential
Grand Union Studios
332 Ladbroke Grove
W10 5AD

Email: hello@lbresidential.co.uk
Web: www.lbresidential.co.uk
Tel: 0203 062 6262