

## Downham Crescent, Wymondham, NR18

£499,500

4 2 2



Moneyproperties are delighted to bring to market this spacious four double bedroom detached family home located on a desirable cul de sac and occupying a generous plot. The property comprises of an entrance hall with downstairs wc, 18ft living room with feature fireplace and bay fronted window, kitchen/breakfast room with separate utility and a good-sized dining room leading to the conservatory. To the upstairs comes four well-proportioned double bedrooms, ensuite and walk-in wardrobe to bedroom one, family bathroom off the landing. The property enjoys generous front and rear gardens, double garage and ample off-road parking.

**Tenure: Freehold EPC: D Council Tax: E**

## Key Features

- Spacious four double bedroom detached family home
- Double garage with off-road parking
- Good-sized dining room leading to the conservatory
- Ensuite and walk-in wardrobe to bedroom one
- Located down a desirable cul de sac and occupying a generous plot
- Comes to market for the first time in over 30 years
- 50ft enclosed rear garden with a summer house
- 14ft kitchen/breakfast room with separate utility room
- 18ft living room with bay fronted window
- See our full online listing for further details including flood risk, broadband speed and other material information.

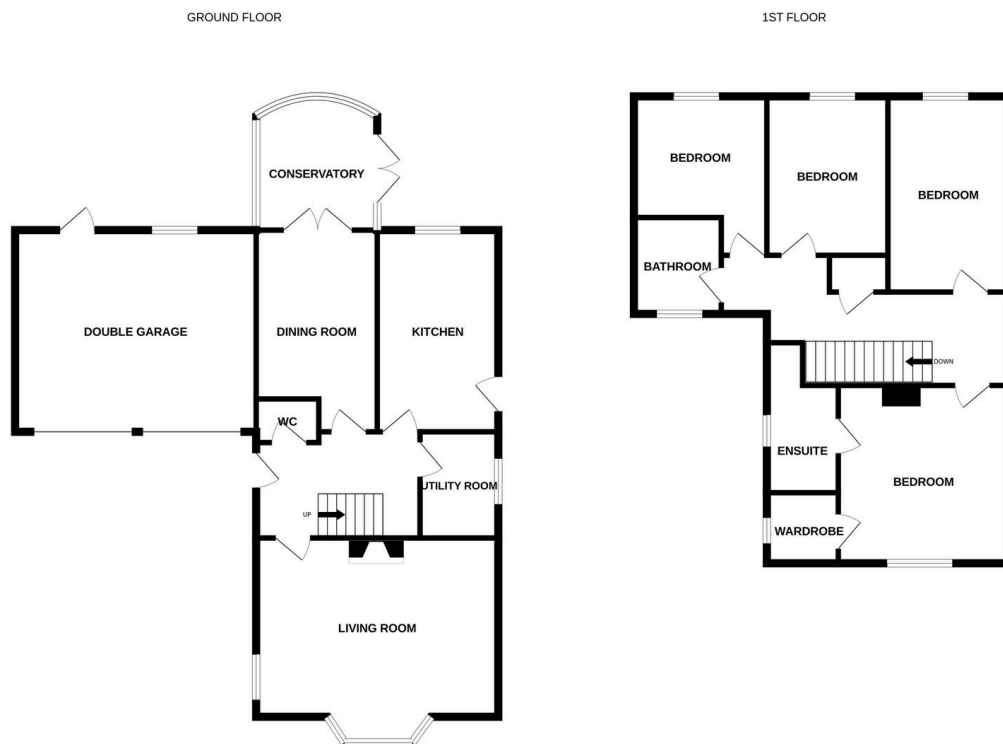

Whilst every attempt has been made to ensure the accuracy of the floorplan contained here, measurements of doors, windows, rooms and any other items are approximate and no responsibility is taken for any error, omission or mis-statement. This plan is for illustrative purposes only and should be used as such by any prospective purchaser. The services, systems and appliances shown have not been tested and no guarantee as to their operability or efficiency can be given.  
Made with Metropix ©2025