

Attleborough Road, Deopham, Wymondham, Norfolk

Offers In Region Of £680,000

5 2 4



Moneyproperties proudly presents Chase End, a detached five-bedroom bungalow offering approximately 2200 sq ft of living space, complemented by 1000 sq ft of garage space and 950 sq ft of outbuildings on a plot just under 0.75 acres. The property features a spacious kitchen/dining area with an Aga, a cosy living room with a wood-burning stove, a games room, a garden room, multiple garages, solar panels with FIT payout. and storage sheds. With field views to the front and rear, a landscaped rear garden, summer house, greenhouse, pavilion, and BBQ room, this home is perfect for a large family, dual families, or those seeking a home business setup.

Tenure: Freehold EPC: TBC Council Tax: B

Key Features

- Stunning detached five bedroom bungalow offering approximately 2200 sq ft of living space
- Ideally situated for the main A11 for those looking for easy access to both Norwich and Cambridge
- 30ft Kitchen / Dining area with modern kitchen, island and Aga perfect for large or dual families
- For those who love the Norfolk countryside with field views to the front and the rear of the property
- Sitting on a generous plot close to 0.75 acres with approx 1000sq ft of multiple garages and storage sheds
- Benefiting from a generous solar panel income of around £3000 per year.
- Conveniently located for access to Norfolk market towns of Wymondham and Attleborough
- Rear Garden measures approximately 160ft x 80ft and houses various storage sheds and workshops
- Ideal home for those who want to set up a business from home or love entertaining
- See our full online listing for further details including flood risk, broadband speed and other material inform

GROUND FLOOR

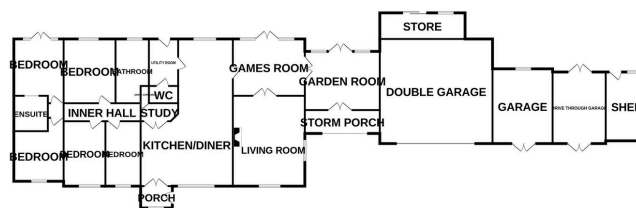

OUTBUILDINGS

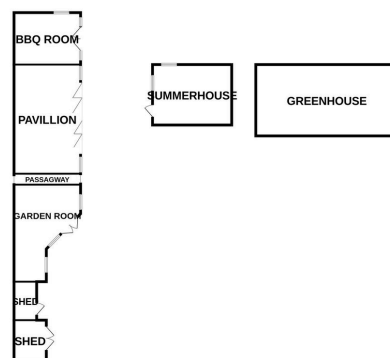

Whilst every attempt has been made to ensure the accuracy of the floorplan contained here, measurements of doors, windows, rooms and any other items are approximate and no responsibility is taken for any error, omission or mis-statement. This plan is for illustrative purposes only and should be used as such by any prospective purchaser. The services, systems and appliances shown have not been tested and no guarantee as to their capability or efficiency can be given.
Made with Metropix (2024)