

Daintree, Needingworth, St. Ives, PE27 4SP

Offers Over £650,000

5 3 3



A detached property with extensive accommodation over 3,000 square foot and a substantial plot with countryside beyond.

Key Features

- Executive Detached Home
- Substantial Plot Surrounding The Property
- Over 3,000 Square Foot
- Village Location Close To Amenities
- Virtual Tour Available Upon Request
- Four/Five Double Bedrooms
- Countryside Views
- Three/Four Reception Rooms
- Detached Garage And Ample Parking
- EPC Rating: TBC

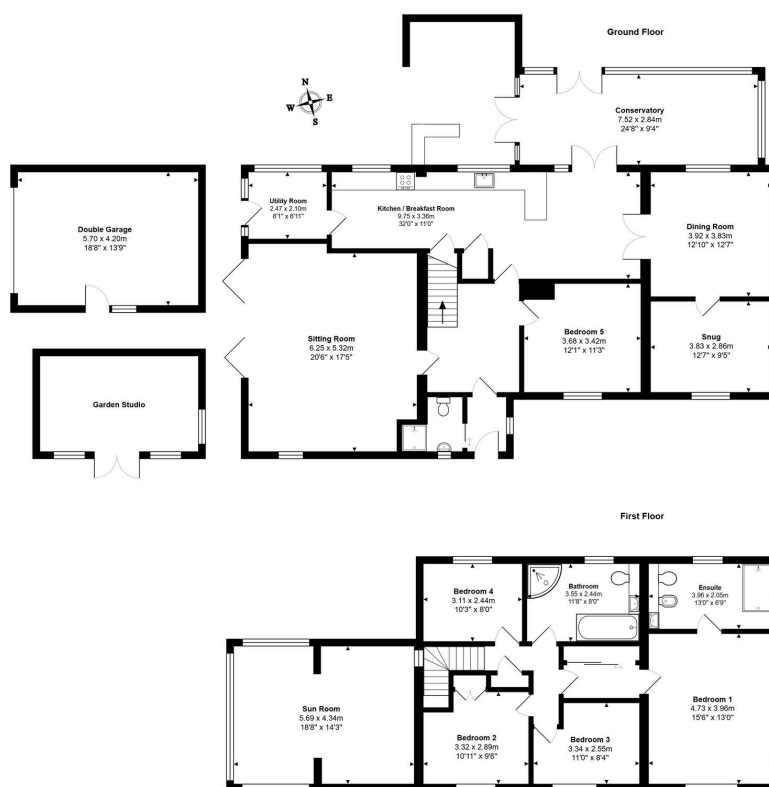

Total Area: 287.3 m² ... 3092 ft² (excluding double garage)
All measurements are approximate and for display purposes only