



HEARTWOOD
HOMES

Watling Street, Park Street, St. Albans, AL2 2NN

£350,000

🛏️ 2 🚿 1 🚺 1



This spacious and well-presented two-bedroom first-floor maisonette is located in the charming Park Street village. The property enjoys a prime position, with easy access to a variety of local shops and excellent motorway connections. Popular schools are nearby, and St Albans City Centre, with its vibrant shopping, dining, and transport options, is just a short drive away.

The home offers generous living space, starting with an entrance hall leading up to a large landing with access to the loft. At the front, you'll find a bright and spacious living room, while the rear features a modern and well-equipped kitchen/dining room. There are two good-sized double bedrooms and a contemporary bathroom.

Externally, the property benefits from a brick-built outbuilding, providing useful storage space, and a large garden that is perfect for family gatherings and entertaining.

Contact us today to arrange a viewing of this wonderful home!



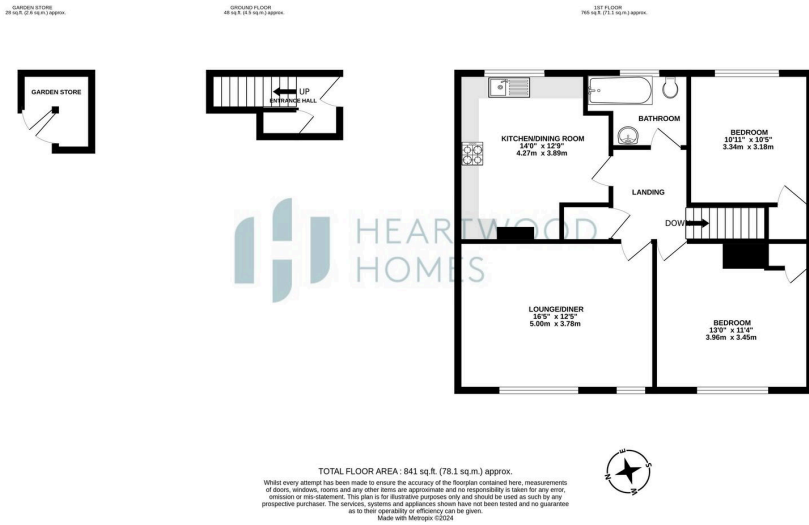

- Spacious two-bedroom first-floor maisonette in Park Street
- Bright and airy living room
- Two well-proportioned double bedrooms
- Convenient location close to local shops
- Short drive to St Albans City Centre with shops, restaurants, and transport links
- Large garden ideal for family gatherings and entertaining
- Modern kitchen/dining room with contemporary fittings
- Stylish, updated bathroom
- Excellent access to motorway networks
- EPC Grade

