



940 Wolseley Road, Saltash Passage, Plymouth, Devon, PL5 1LB

£450,000



Welcome to Tamar View, a stunning modern townhouse perfectly positioned on the tranquil banks of the River Tamar. This exceptional semi-detached property offers breathtaking, uninterrupted views across the water to Saltash and East Cornwall, with the iconic Tamar Bridge framing the horizon. For boat lovers and waterside enthusiasts, Tamar View is nothing short of a dream come true.

Set over three spacious and thoughtfully designed floors, this home combines contemporary living with the peace and beauty of a waterside setting. Upon arrival, you'll find private parking and a single garage located at the rear of the property, ensuring convenience alongside comfort.

The ground floor hosts three well-proportioned bedrooms and a stylish family bathroom. Whether used as guest rooms, home offices, or spaces for growing families, these rooms offer flexibility to suit your lifestyle. Clever built-in storage solutions make the most of the available space.

The heart of the home lies on the first floor — a stunning open-plan kitchen, dining, and living area designed to maximise the panoramic river views. The space is perfect for entertaining or simply unwinding while watching the boats glide along the water. Large windows flood the space with natural light, creating a calm and inviting atmosphere year-round whilst there is gas underfloor heating in this room making it a cosy and warm retreat in the winter months.

The top floor is dedicated to a luxurious master suite. A generous master bedroom with dual eaves storage opens onto a private sun terrace, providing the ultimate place to relax and soak in the sights and sounds of the river. The suite also includes a stylish en-suite bathroom with a separate shower cubicle and bath, adding a layer of comfort and privacy. There is also a very handy storage cupboard.

Tamar View is more than just a home — it's a lifestyle. With direct sea views, a prestigious waterfront location, and modern, flexible accommodation, this unique property is an exceptional opportunity for those seeking peace, beauty, and a strong connection to the water.

For investors or those seeking a dual-purpose home, Tamar View has also proven to be a successful holiday let for many years, offering an established income stream in a highly sought-after location.

Don't miss your chance to own this remarkable riverside retreat.



To view this property call Lang Town & Country Estate Agents on [01752 200909](tel:01752200909).



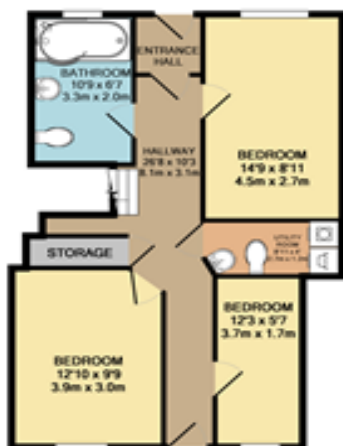

TOTAL APPROX. FLOOR AREA 1368 SQ. FT. (125.5 SQ. M.)

While every attempt has been made to ensure the accuracy of the floor plan contained here, measurements of doors, windows, rooms and any other items are approximate and no responsibility is taken for any error, omission, or misstatement. This plan is for illustrative purposes only and should be used as such by any prospective purchaser. The services, systems and appliances shown have not been tested and no guarantee as to their operability or efficiency can be given.
Made with Metaplan 6/20/17

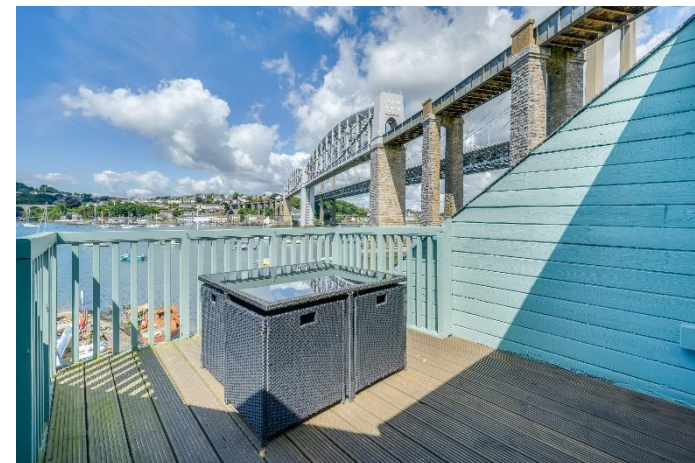

Lang Town & Country
6 Mannamead Road
Mutley
Plymouth
Devon
PL4 7AA
Email: waterside@langtownandcountry.com
Tel: 01752 200909

Lang Town & Country endeavour to ensure the accuracy of property details produced and displayed, we have not tested any apparatus, equipment, fixtures, fittings or services and so cannot verify that they are connected, in working order or fit for purpose. A buyer must check the availability of any property and make an appointment to view before embarking on any journey to see a property.

