



Ian Anthony

The Estate Agents

Willow Drive, Skelmersdale, WN8 8PJ

Guide Price £180,000

3 1 1



- SEMI DETACHED PROPERTY • LIVING ROOM
- KITCHEN
- THREE BEDROOMS
- POPULAR RESIDENTIAL LOCATION
- BATHROOM & SEPARATE WC
- SIDE AND REAR GARDEN



This semi-detached property is situated on Willow Drive, Skelmersdale, offering convenience for both Skelmersdale and Ormskirk town centres, along with their associated amenities and transport links. The ground floor comprises an entrance hall, a comfortable living room, and a kitchen. On the first floor, there are three bedrooms, a family bathroom, and a separate WC. Externally, the property features a low-maintenance enclosed garden, with potential for creating parking to the side. Viewing is highly recommended to appreciate the potential this property has to offer!

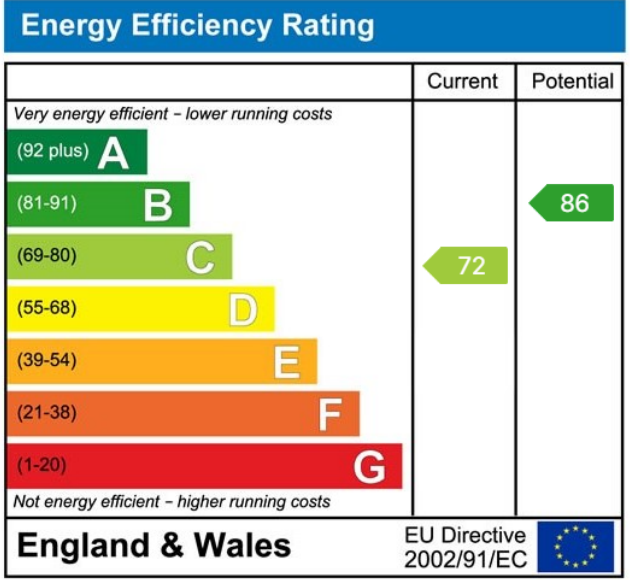
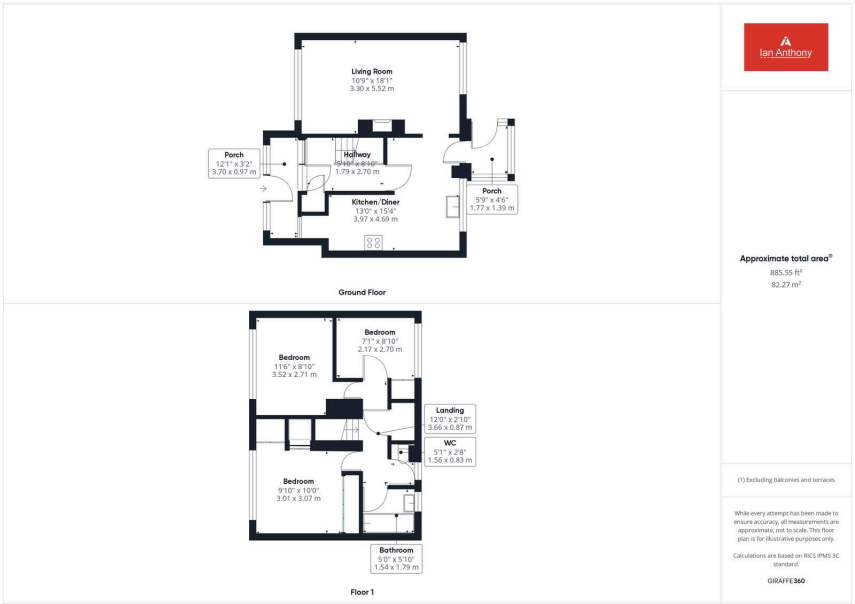

These particulars, whilst believed to be accurate are set out as a general outline only for guidance and do not constitute any part of an offer or contract. Intending purchasers should not rely on them as statements of representation of fact, but must satisfy themselves by inspection or otherwise as to their accuracy. No person in this firm's employment has the authority to make or give any representation or warranty in respect of the property.