



Ian Anthony

The Estate Agents

Lea Crescent, Ormskirk, L39 1PG

Guide Price £164,250

🛏️ 3 🚿 1 🛋️ 2

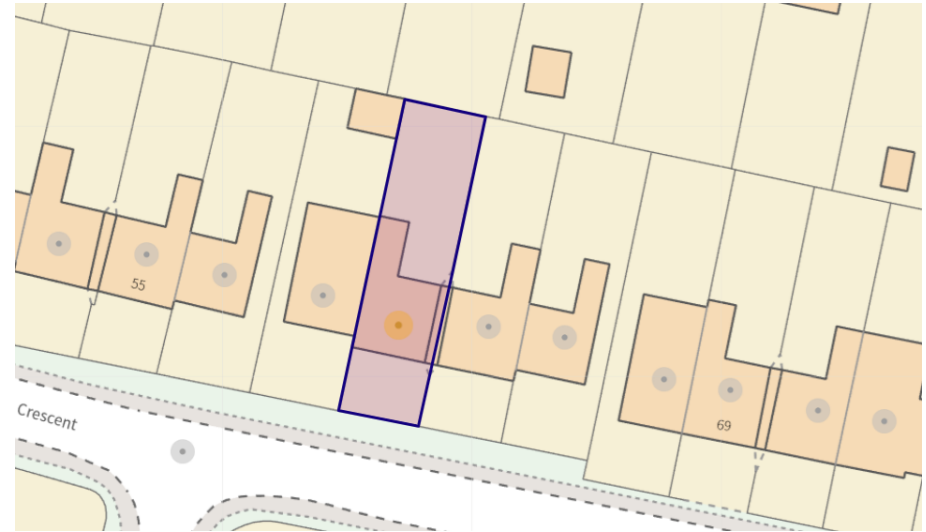

- NO UPWARD CHAIN
- TERRACED PROPERTY
- FAMILY BATHROOM
- KITCHEN/DINER
- CONVENIENT FOR ORMSKIRK TOWN CENTRE
- THREE BEDROOMS
- LIVING ROOM
- OUTBUILDINGS



NO UPWARD CHAIN

We are delighted to bring to market this three-bedroom terraced property situated on Lea Crescent, Ormskirk. The ground floor accommodation comprises a spacious living room and a kitchen/diner, perfect for family gatherings and entertaining. On the first floor, there are three well-proportioned bedrooms and a family bathroom. Outside, the property benefits from two very useful brick-built outbuildings, including a WC, a coal shed, and a storage shed. Located in a popular residential area, this property is convenient for Ormskirk town centre, shopping amenities, transport links, and schools. Viewing is essential to appreciate the full potential and charm this property has to offer!

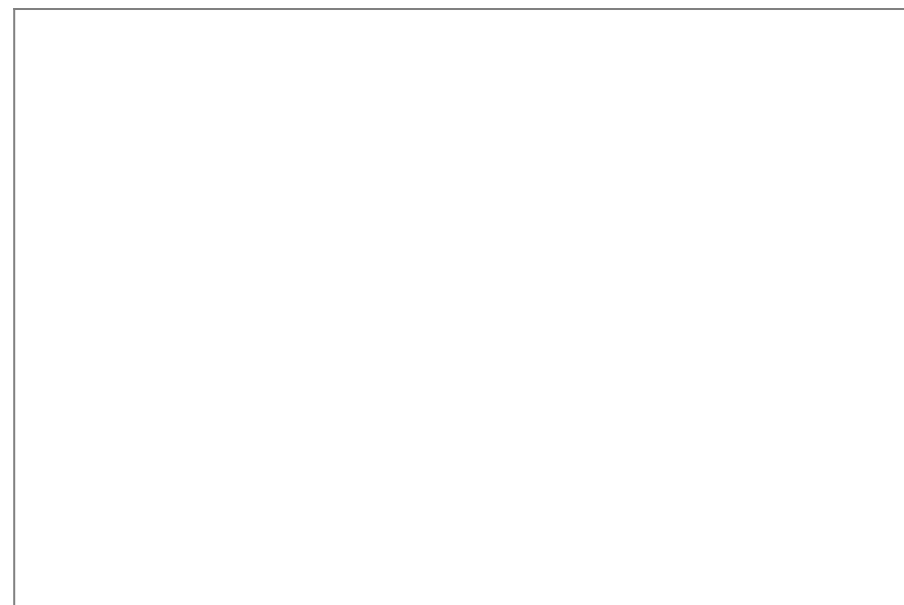
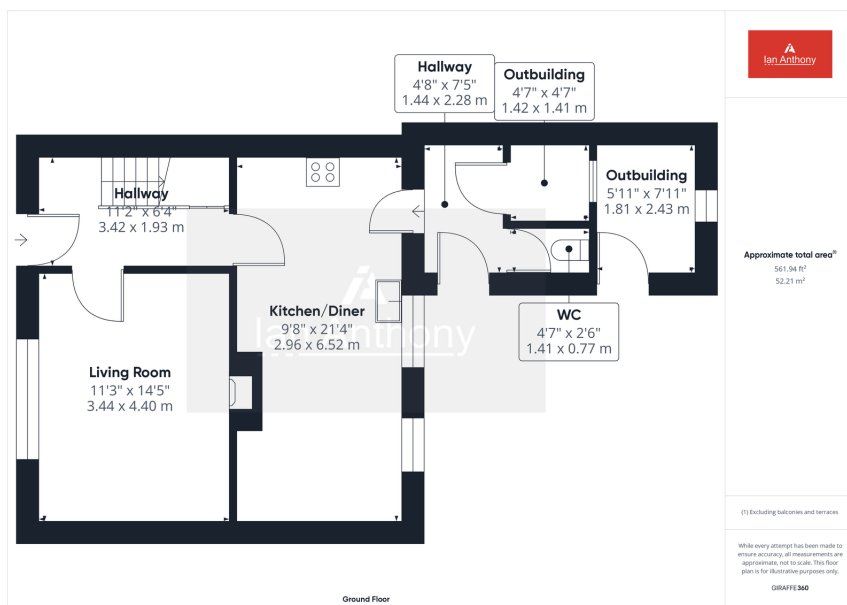

These particulars, whilst believed to be accurate are set out as a general outline only for guidance and do not constitute any part of an offer or contract. Intending purchasers should not rely on them as statements of representation of fact, but must satisfy themselves by inspection or otherwise as to their accuracy. No person in this firm's employment has the authority to make or give any representation or warranty in respect of the property.

5 Burscough Street, Ormskirk, Lancashire, L39 2EG

Tel: 01695 580888 Email: enquiries@iananthonyestates.co.uk <https://www.iananthonyestates.co.uk>