



Ian Anthony

The Estate Agents

Moss Delph Lane, Aughton, L39 5BH

Offers In Region Of £425,000

🛏️ 4 🚿 1 🛋️ 3



- NO CHAIN!
- FULL RENOVATION NEEDED
- FOUR BEDROOMS
- DETACHED DORMER BUNGALOW
- LOCATED IN THE PRESTIGIOUS AUGHTON AREA
- PLENTY OF POTENTIAL
- LARGE SPACIOUS PROPERTY
- SWEEPING DRIVEWAY
- GREAT TRANSPORT LINKS NEARBY
- CATCHMENT AREA FOR GREAT SCHOOLS



Located in the prestigious Aughton area, this detached dormer bungalow presents a rare opportunity for those seeking a property to renovate and make their own. Set on a generous plot and offered with no upward chain, this charming home offers endless potential for transformation. The ground floor includes an entrance hall leading to a spacious living room, a bright garden room, a kitchen/breakfast room perfect for family meals, a utility room, and a dining room, along with two well-sized bedrooms that share a convenient Jack & Jill cloakroom. Upstairs, there are two additional bedrooms and a family bathroom, providing ample space for family or guests. Outside, the property benefits from a detached garage and well-established gardens to both the front and rear, offering privacy and plenty of outdoor space for landscaping or leisure.

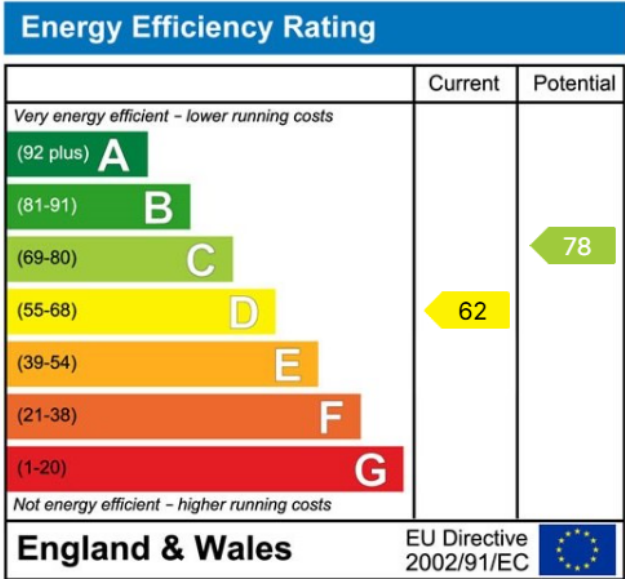
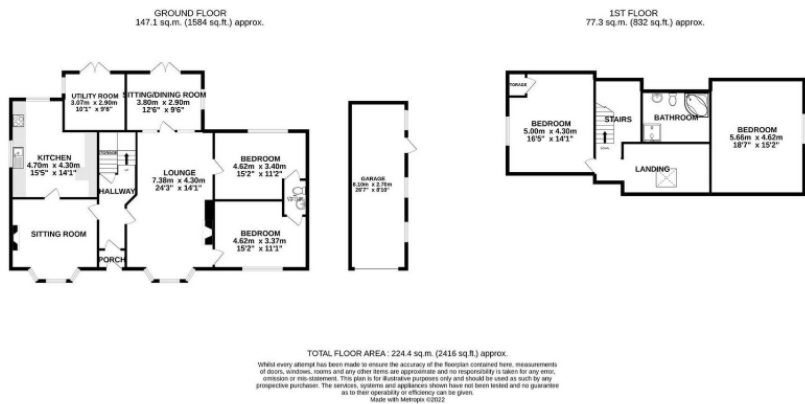

These particulars, whilst believed to be accurate are set out as a general outline only for guidance and do not constitute any part of an offer or contract. Intending purchasers should not rely on them as statements of representation of fact, but must satisfy themselves by inspection or otherwise as to their accuracy. No person in this firm's employment has the authority to make or give any representation or warranty in respect of the property.