



# Ian Anthony

The Estate Agents

# Crosshall Brow, Westhead, L40 6JE

Guide Price £239,950

🛏️ 3 🪑 2 🚗 2



- NO CHAIN!
- COUNTRYSIDE VIEWS FROM FRONT AND REAR
- THREE BEDROOMS
- SEMI DETACHED
- OPPORTUNITY FOR AN EXTENSION
- CLOSE TO ORMSKIRK HIGH SCHOOL
- GREAT TRANSPORT LINKS
- UTILITY
- DRIVEWAY
- SOUTH FACING GARDEN



Nestled in the picturesque village of Westhead, this three-bedroom semi-detached home offers a wonderful blend of countryside charm and family convenience. Ideally suited for families, the property is within easy reach of Ormskirk High School and other local amenities, while offering beautiful countryside views both to the front and rear.

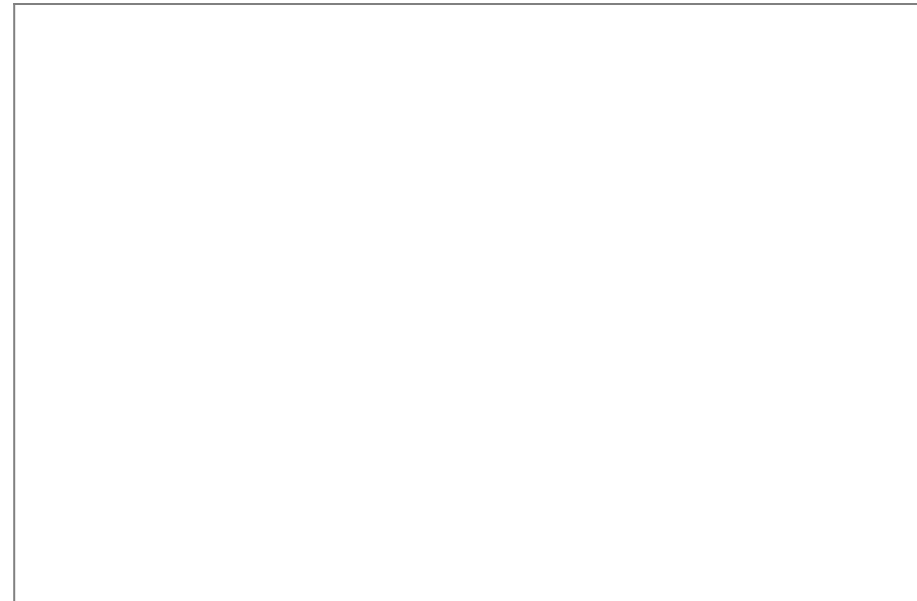
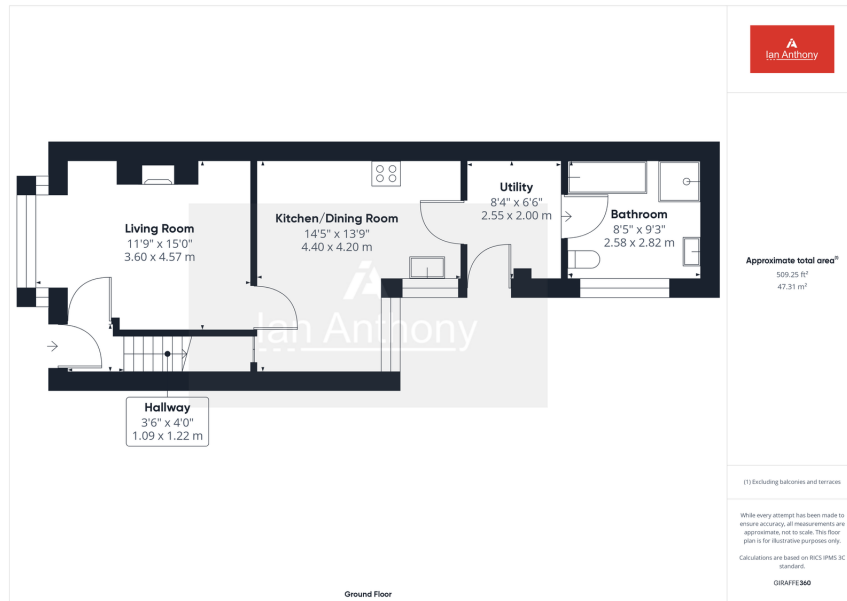

These particulars, whilst believed to be accurate are set out as a general outline only for guidance and do not constitute any part of an offer or contract. Intending purchasers should not rely on them as statements of representation of fact, but must satisfy themselves by inspection or otherwise as to their accuracy. No person in this firm's employment has the authority to make or give any representation or warranty in respect of the property.