

Apartment 1, Minerva Place, Whitbarrow Road, Lymm WA13 9AG

£185,000

🛏 1 🍽 1 🚗 1



Superb one bedroom ground floor retirement apartment in a recently built small development a few minutes walk from Lymm village centre. Secure access, car parking and pretty communal gardens compliment this beautifully presented apartment with direct access onto the sunny terrace garden. The apartment is bright and spacious with open plan living/dining kitchen, bedroom, well appointed shower room, storage cupboards. Internal viewing is highly recommended. NO CHAIN. Over 55's only. First years service charge paid.

Key Features

- Ground floor apartment in a stylish recently built development for over 55's
- Excellent internal specification of all communal areas and the apartment
- Bright and spacious apartment with French doors to rear terrace garden - providing private entrance
- Support package if required including emergency call system and lifestyle manager in daily attendance
- Beautifully landscaped gardens
- Allocated and visitor parking - including EV spaces
- Communal lounge, dining area and Wellness Suite
- 10 year build warranty
- Short walk to Lymm village and all amenities, Trans Pennine Trail and Bridgewater Canal
- FIRST YEARS SERVICE CHARGE PAID

Ground Floor

Approx. 43.5 sq. metres (468.2 sq. feet)

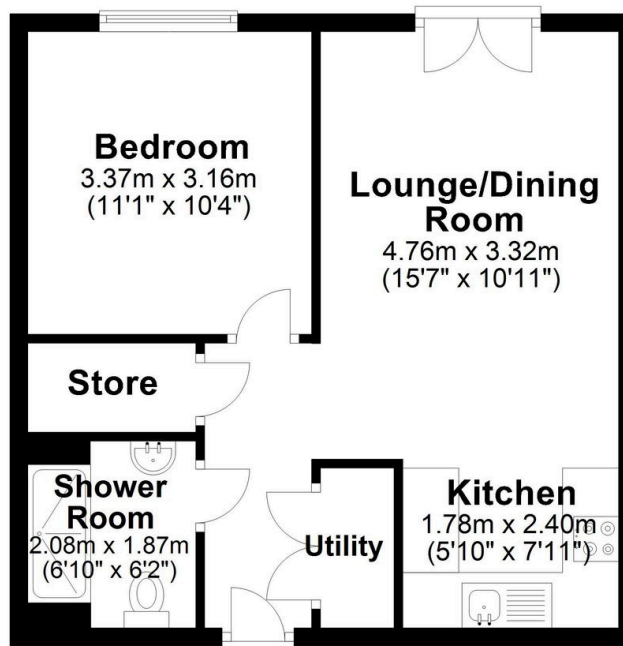

Total area: approx. 43.5 sq. metres (468.2 sq. feet)

Measurements of rooms and any other items are approximate and no responsibility is taken for any misstatement. This plan is for illustrative purposes only and should be used as such. Produced by OpenInsight.co.uk
Plan produced using PlanUp.