



HEATHER PORTER

exp<sup>®</sup> UK

@heather.porter@exp.uk.com

heatherporter.exp.uk.com

07811 129 251



Lower Compton, Plymouth, Devon, PL3 5ET

£250,000

3 1 1





- QUOTE REFERENCE HP0686
- FOR ALL ENQUIRIES / VIEWINGS
- LARGE LOUNGE/DINING ROOM
- THREE BEDROOMS
- NEW FLOORING THROUGHOUT
- GARDEN TO THE FRONT, LOW MAINTENANCE SOUTH-FACING GARDEN TO THE REAR
- BRIGHT, SPACIOUS SEMI-DETACHED HOME IN POPULAR LOCATION
- NEWLY FITTED KITCHEN WITH INTEGRATED APPLIANCES
- NEW THREE PIECE BATHROOM SUITE WITH SHOWER OVER BATH
- GAS CH & uPVC DOUBLE GLAZING
- SINGLE GARAGE WITH UTILITY SPACE



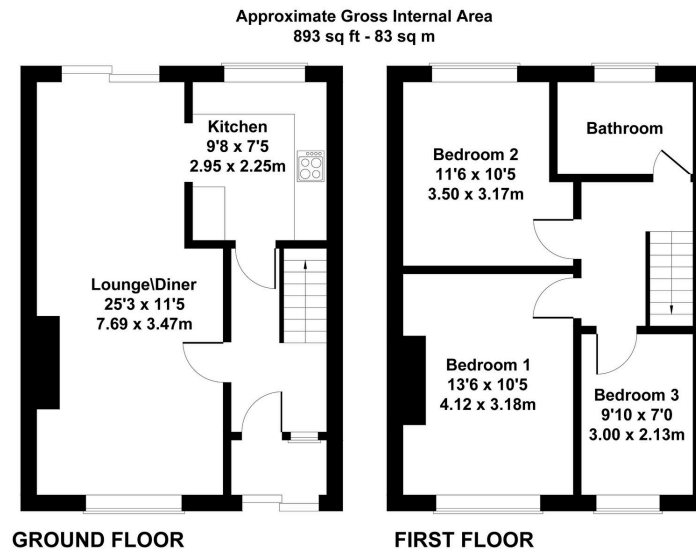

Not to Scale. Produced by The Plan Portal 2024  
For Illustrative Purposes Only.

If it's a light, bright and airy home you are looking for, with a large lounge/dining room, recently fitted kitchen & bathroom and three good sized bedrooms, this has it all. Semi detached house, front garden and south-facing, low maintenance to the rear with a single garage, in the heart of Lower Compton. Book a viewing today - quote reference HP0686.

