



MH

Victoria Road

Welcome to this stunning and versatile five-bedroom family home, newly renovated and meticulously crafted to an exceptional standard.

WWW.MARCOHARRIS.CO.UK

2024 COLLECTION



www.marcoharris.co.uk

For Sale

Welcome to this stunning and versatile five-bedroom family home, newly renovated and meticulously crafted to an exceptional standard. Spread across three beautifully designed floors, this property perfectly balances modern elegance with practical living, offering ample space for comfort, functionality, and style. From the exquisite carpentry throughout to luxurious features like a TV in the main bathroom, every detail has been carefully considered to create a truly remarkable home.

Setting

Netley Abbey, Southampton Situated in the picturesque village of Netley Abbey on the eastern shore of Southampton Water, this location is ideal for families seeking a peaceful yet well-connected community. Netley Abbey offers a serene environment, scenic views, and a rich historical backdrop, complemented by excellent local schools such as Netley Abbey Infant and Junior Schools and The Hamble School. Families will enjoy the abundance of green spaces, including the nearby Royal Victoria Country Park – perfect for walks, picnics, and outdoor adventures. Local amenities, charming shops, and cafes provide convenience without the hustle and bustle of city living, making Netley Abbey a truly desirable place to call home.





The kitchen itself is a masterpiece of bespoke craftsmanship, featuring beautifully handmade wooden cabinetry, sleek quartz worktops, and high-quality integrated appliances. It is both stylish and functional, ideal for family meals or hosting dinner parties.



The Ground Floor

Upon entering, you are welcomed into a spacious and stylish living room, ideal for relaxing or entertaining guests. The heart of the home is undoubtedly the expansive open-plan kitchen and living area at the rear, where stunning herringbone-style engineered oak flooring sets the tone for elegance and warmth. This bright, versatile space is flooded with natural light, enhanced by bi-fold doors that seamlessly connect the indoors to the landscaped rear garden, perfect for indoor-outdoor living.

The kitchen itself is a masterpiece of bespoke craftsmanship, featuring beautifully handmade wooden cabinetry, sleek quartz worktops, and high-quality integrated appliances. It is both stylish and functional, ideal for family meals or hosting dinner parties. Adjacent to the kitchen is a practical utility room and a boot room, providing additional storage and laundry facilities. Completing the ground floor is a flexible reception room that can serve as a study, snug, or sixth bedroom, along with a convenient W.C.

The First Floor

The first floor offers four generously proportioned bedrooms, each thoughtfully designed to maximise comfort and natural light. Bedrooms 2, 3, 4, and 5 are versatile spaces, perfect for family members, guests, or home office setups. This level also benefits from two beautifully finished bathrooms: a modern family bathroom with contemporary fixtures and a separate shower room, ensuring stress-free mornings for the entire household.

The Second Floor

The top floor is reserved for the exceptional main bedroom suite, providing a private sanctuary away from the hustle and bustle of family life. This luxurious space features a spacious walk-in wardrobe and an en-suite bathroom designed with sleek modern fittings and added indulgence, including a built-in TV for ultimate relaxation. French doors open onto a charming balcony with breathtaking views over Southampton Water, the perfect spot to unwind with a morning coffee or enjoy a sunset.

The Finishing Touches

Throughout the home, you will find impeccable attention to detail, from the outstanding carpentry to the high-quality finishes that elevate the décor. Herringbone-style engineered oak flooring in the kitchen adds timeless elegance, while the thoughtful layout and premium fixtures create a space that is both beautiful and functional. A Home for Every Lifestyle This exceptional property is ideal for growing families, multi-generational living, or professionals seeking flexible work-from-home options. With its thoughtful design, versatile living spaces, and stunning interiors, this home offers an unparalleled lifestyle of comfort and luxury, ready to welcome its next chapter.

Garden and Grounds

Outside, the property benefits from a brand-new driveway, providing ample parking for multiple vehicles, making it ideal for families and guests. Side access leads you to the rear garden, a generous space that serves as a blank canvas, ready for the new owners to create their dream outdoor haven. Whether you envision a modern landscaped design, family play area, or tranquil retreat, the possibilities are endless. To inspire your vision, designs and plans are available upon request, showcasing the garden's full potential.







Ground Floor



First Floor

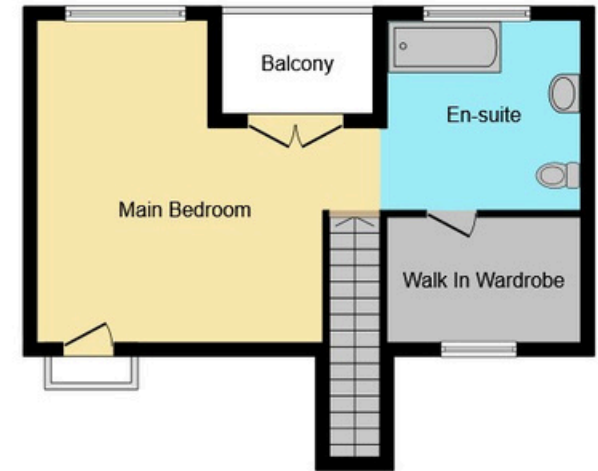

Second Floor

- Bedroom Six / Snug - 3.20m x 3.14m (10'5" x 10'3")
- Utility Room - 3.01m x 2.30m (9'10" x 7'6")
- Bedroom 2 - 5.64m x 3.00m (18'6" x 9'10")
- Bedroom 3 - 3.00m x 3.13m (9'10" x 10'3")
- Bedroom 4 - 2.91m x 3.15m (9'6" x 10'4")
- Bedroom 5 - 3.01m x 2.67m (9'10" x 8'9")
- Study - 2.05m x 1.77m (6'8" x 5'9")
- Main Bedroom - 5.46m x 4.52m (17'10" x 14'9")
- Walk In Wardrobe - 3.01m x 2.33m (9'10" x 7'7")

This floor plan is for illustrative purposes only. It is not drawn to scale. Any measurements, floor areas (including any total floor area), openings and orientations are approximate. No details are guaranteed, they cannot be relied upon for any purpose and do not form any part of any agreement. No liability is taken for any error, omission or misstatement. A party must rely upon its own inspection(s). Powered by www.Propertybox.io

Two brass door knobs are mounted on a dark, vertically-grained wooden door. The knobs are positioned in the center-left of the image, with the one in the foreground being slightly more prominent.

Contact Us

www.marcoharris.co.uk
02381 733330

Brockenhurst

Office 102,
The Incuhive
Grigg Lane
SO42 7RE

Park Gate

68 Botley Road
Park Gate
Southampton
SO31 1BB