

# EUGEN COTORANU



## Otterburn Gardens

£1,850PCM (Deposit: £1,850)

3 2 2



Score	Energy rating	Current	Potential
92+	A		
81-91	B		
69-80	C		71 C
55-68	D	65 D	
39-54	E		
21-38	F		
1-20	G		

**Spacious and well-presented GROUND FLOOR TWO-DOUBLE BEDROOM maisonette** with a charming Private Garden. Perfectly located just a 5-MINUTE WALK from Syon Lane Train Station, shops, and independent restaurants. Please quote EC0801

**SELL | BUY | LET | INVEST**

07774 807085 | eugen.cotoranu@exp.uk.com

# EUGEN COTORANU

POWERED BY  
**exp** UK

- Please quote EC0801
- Recently Refurbished
- Two Double Bedrooms
- Fully Furnished
- Private Front Garden
- Modern Ground Floor Maisonette
- Excellent Transport Facilities Nearby
- Spacious Reception Room
- Wood flooring
- Ample Storage

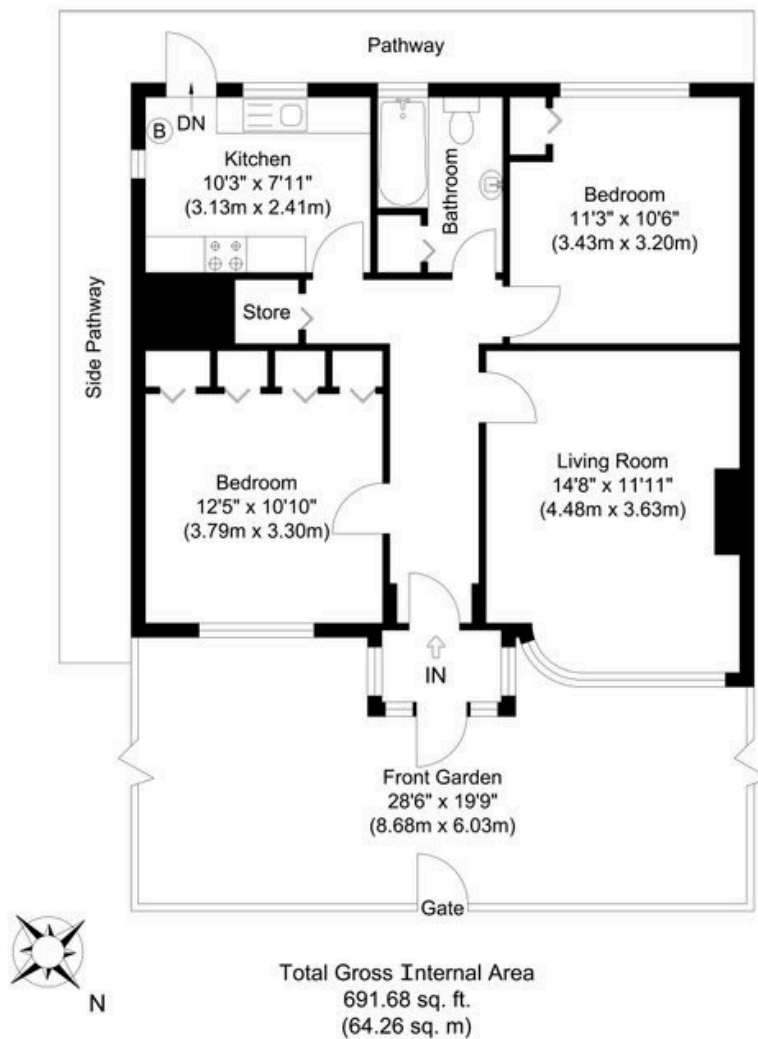

Ground Floor, Otterburn Gardens, Isleworth, TW7

Illustration for identification purposes only, measurements are approximate, not to scale.

**SELL | BUY | LET | INVEST**

07774 807085 | [eugen.cotoranu@exp.uk.com](mailto:eugen.cotoranu@exp.uk.com)