

Ravensmead Road

Guide Price £550,000 - £600,000

3 1 2

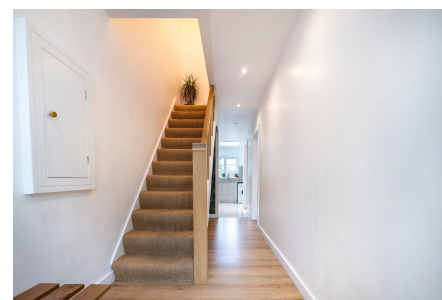

Please Quote RF0924 for all Enquires

GUIDE PRICE £550,000 - £600,000. This beautifully renovated three-bedroom mid-terrace home in Bromley offers modern living with two spacious reception rooms, a luxury kitchen, and a landscaped low-maintenance garden. The property features a contemporary bathroom with a separate WC and benefits from a prime location with easy access to local amenities, schools, and transport links. With its stylish interiors and thoughtful design, it's perfect for families or professionals.

Key Features

- Please Quote RF0924 for all Enquires
- Recently Renovated Throughout
- Two Spacious Reception Rooms
- Landscaped Rear Garden
- Close to Bromley's amenities, schools, and excellent transport links
- GUIDE PRICE £550,000 - £600,000
- Three Generously Sized Bedrooms
- Modern Luxury Kitchen
- Stylishly Appointed Bathroom
- EPC rating D & Council Tax Band D

Ravensmead Road BR2

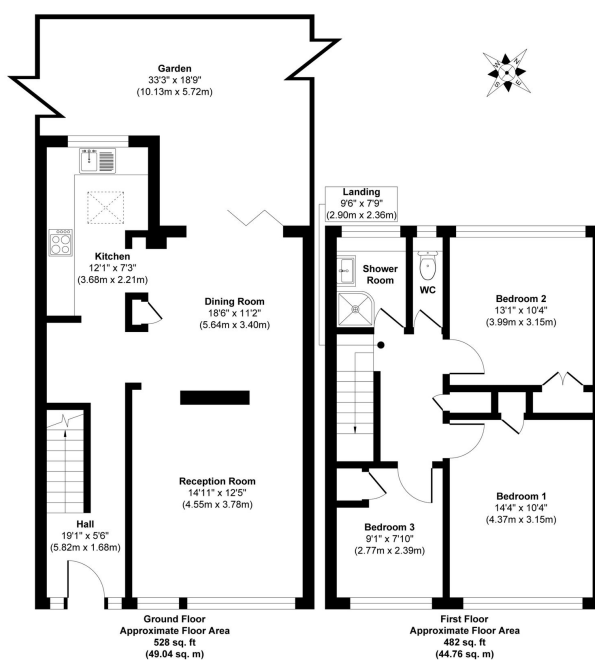

Approx. Gross Internal Floor Area 1010 sq. ft / 93.80 sq. m
Illustration for identification purposes only, measurements are approximate, not to scale.
 Produced by Elements Property