

2 Lon Y Mes, Abergele, Conwy, LL22 7JG

£300,000

3 2 1



Situated within the popular Woodlands Estate and with lovely distant sea views from the rear, this detached bungalow offers well presented accommodation, suited to a wide range of buyers. With an open plan reception room and kitchen, large lounge and conservatory the property has an abundance of space, together with three bedrooms, the master having ensuite facility. There is a single garage, ample parking and a fully enclosed rear garden. Abergele has a variety of shops including Tesco, schools for all age groups, leisure facilities and medical centre. The A55 Expressway is within two miles.

Key Features

- Detached bungalow
- Modern fittings
- Ensuite
- Lawn gardens
- EPC - C
- Versatile and spacious
- Three bedrooms
- Sea views
- Garage
- Council tax band - E

Approx Gross Internal Area
99 sq m / 1067 sq ft

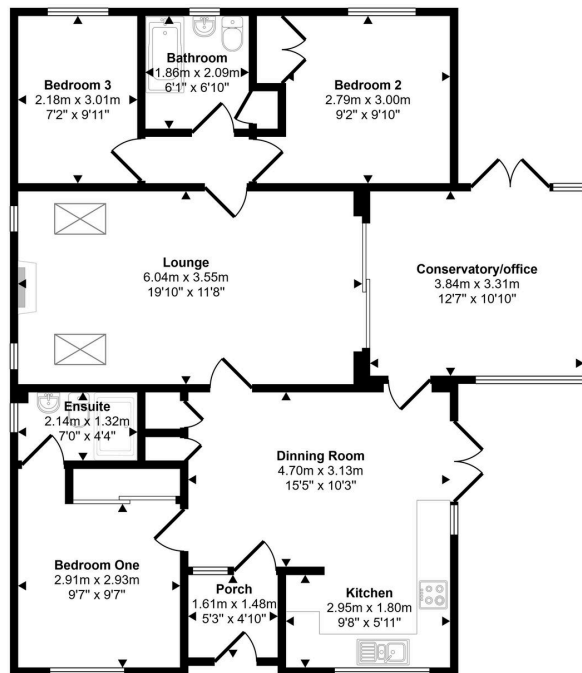

Floorplan

This floorplan is only for illustrative purposes and is not to scale. Measurements of rooms, doors, windows, and any items are approximate and no responsibility is taken for any error, omission or mis-statement. Icons of items such as bathroom suites are representations only and may not look like the real items. Made with Made Snappy 360.

CONSUMER PROTECTION REGULATIONS 2008 AND THE BUSINESS PROTECTION FROM MISLEADING MARKETING REGULATIONS 2008

These particulars, whilst believed to be accurate, are set out for guidance only and do not constitute any part of an offer or contract. Prospective purchasers or tenants should not rely on these particulars as statement or representation of fact, but must satisfy themselves by inspection or otherwise as to their accuracy. No person in the employment of PETER LARGE Estate Agents has the authority to make or give any representation or warranty in relation to the property. Room sizes are approximate and all comments are of the opinion of PETER LARGE Estate agents having carried out a walk through inspection. These sales particulars are prepared under the consumer regulations 2008 and are governed by the business from misleading marketing regulations 2008.