



116 Church Road, Buckley

Offers Over £400,000

116 Church Road, Buckley

Charming Detached Home with Incredible Potential on the Sought-After Church Road, Buckley.

Nestled on the popular Church Road, this characterful three-bedroom detached home offers a fantastic opportunity for those looking to create their dream property. Set on a generously sized plot, the property provides a wealth of potential for extension and customization, perfect for growing families or those wanting extra space.

The exterior features traditional brickwork and period details, giving the house a timeless charm that could be further enhanced with some thoughtful renovations. Inside, the spacious layout presents an excellent canvas for modern updates, allowing you to tailor each room to your taste and lifestyle. To the ground floor you have to spacious reception rooms and large kitchen and to the first floor, three bedrooms and bathroom.

The expansive garden offers privacy and ample room to landscape, entertain, or extend the property (subject to planning permissions), making it ideal for those with a vision for outdoor living.

Situated in a desirable location with convenient access to local amenities, schools, and transport links, this home is perfect for those ready to take on a rewarding project.

**** Additional information ****

In accordance with our client's charitable status (Registered Charity Number: 1142813), the property may remain on the open market until exchange of contracts; our clients reserve the right to consider any other offer which is forthcoming.

This property will be sold subject to our client's standard covenants, further details of which are available upon request.





- NO ONWARD CHAIN
- STUNNING CHARACTER PROPERTY
- SOUGHT AFTER LOCATION
- HUGE POTENTIAL
- SCOPE TO EXTEND (SPP)
- VIEWING IS A MUST





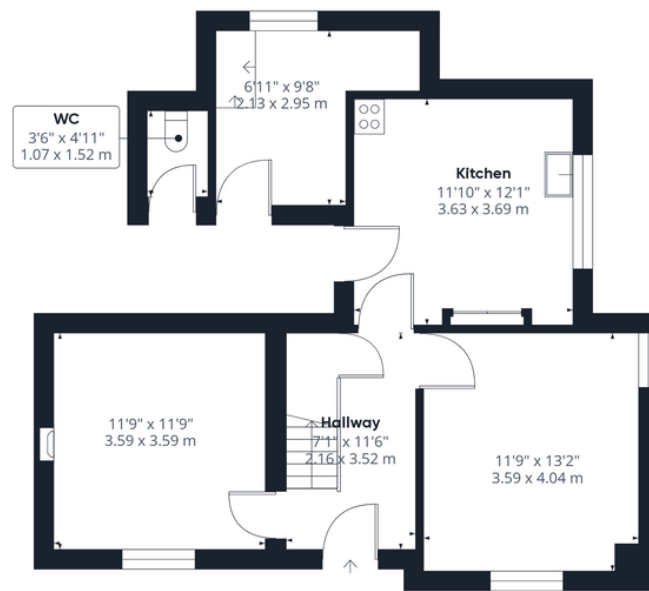

Floor 0

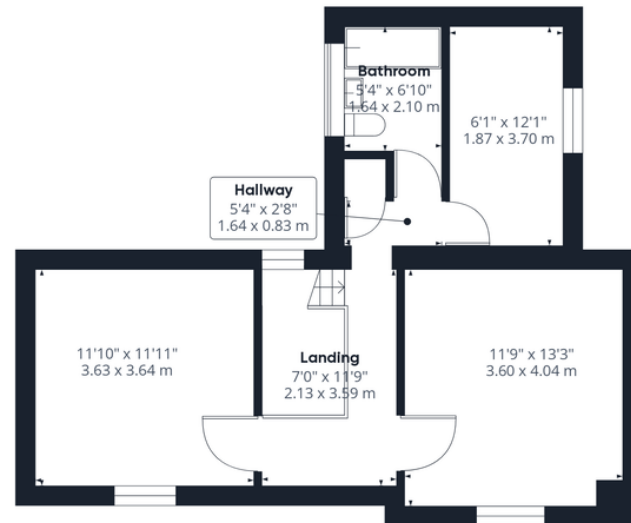

Floor 1

Approximate total area⁽¹⁾
 1110.83 ft²
 103.2 m²

(1) Excluding balconies and terraces

While every attempt has been made to ensure accuracy, all measurements are approximate, not to scale. This floor plan is for illustrative purposes only.

Calculations are based on RICS IPMS 3C standard.

GIRAFFE360