

# Hardie Avenue, Rugeley, WS15 1NU

£170,000

3 1 1



**\*\* ONLINE VIRTUAL TOUR AVAILABLE ON THIS PROPERTY - why not take a peek before booking a viewing\*\***

## Key Features

- NO UPWARD CHAIN
- POPULAR LOCATION
- THREE BEDROOMS
- CLOSE TO AMENITIES
- MODERN KITCHEN
- GOOD SIZE REAR GARDEN
- IDEALLY SUITED FOR FIRST TIME BUYERS
- VIEWING ESSENTIAL

Approx Gross Internal Area  
76 sq m / 814 sq ft

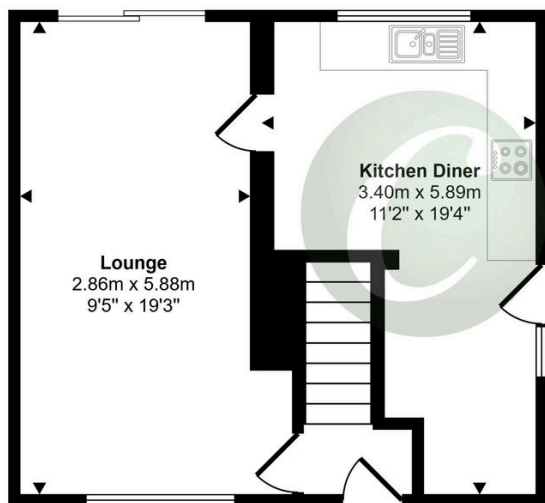

Ground Floor  
Approx 38 sq m / 404 sq ft

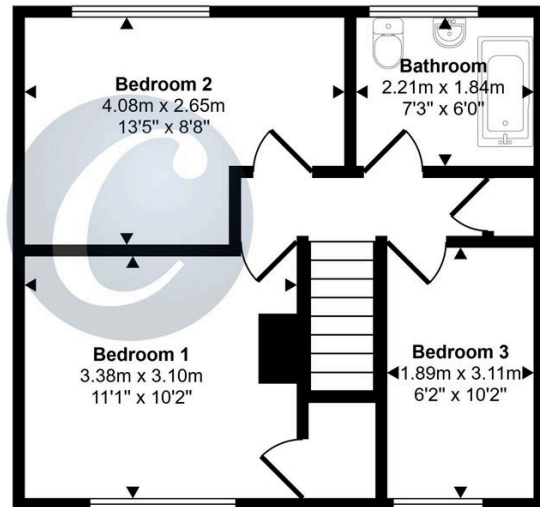

First Floor  
Approx 38 sq m / 410 sq ft

This floorplan is only for illustrative purposes and is not to scale. Measurements of rooms, doors, windows, and any items are approximate and no responsibility is taken for any error, omission or mis-statement. Icons of items such as bathroom suites are representations only and may not look like the real items. Made with Made Snappy 360.