

Watkiss Drive, Rugeley, WS15 2PN

£225,000

3 1 2



- IMMACULATELY PRESENTED THROUGHOUT
- TWO RECEPTION ROOMS
- REAR GARDEN
- POPULAR RESIDENTIAL LOCATION
- THREE BEDROOMS
- MODERN FITTED KITCHEN
- OFF ROAD PARKING
- VIEWING ESSENTIAL

Approx Gross Internal Area
75 sq m / 808 sq ft

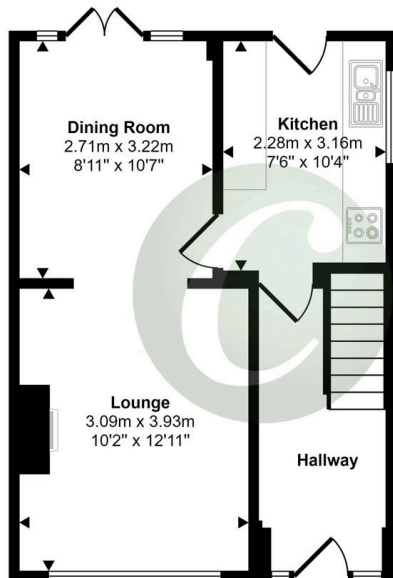

Ground Floor
Approx 37 sq m / 401 sq ft

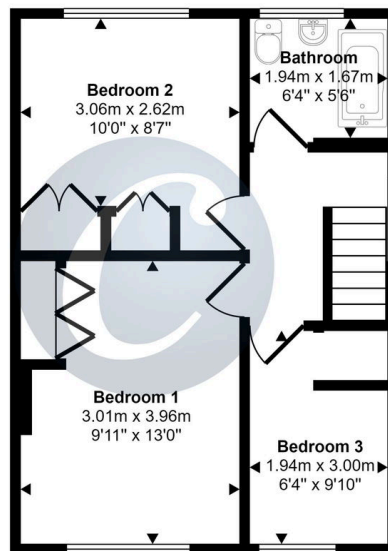

First Floor
Approx 38 sq m / 407 sq ft

This floorplan is only for illustrative purposes and is not to scale. Measurements of rooms, doors, windows, and any items are approximate and no responsibility is taken for any error, omission or mis-statement. Icons of items such as bathroom suites are representations only and may not look like the real items. Made with Made Snappy 360.

**** ONLINE VIRTUAL TOUR AVAILABLE ON THIS PROPERTY - why not take a peek before booking a viewing****