



6 Whinchat Rise,

Guide Price £295,000

DOMINIC MURPHY POWERED BY **exp** TM UK

@ dominic.murphy@exp.uk.com

🌐 dominicmurphy.exp.uk.com

📞 01304 746 016

6 Whinchat Rise,

ALMOST NEW! We are pleased to present this charming mid-terraced house in the popular Richmond Park development. Homes in this desirable estate are in high demand, and it's easy to see why. Whitfield continues to expand and flourish, drawing attention for its growth and the accessibility it offers to numerous surrounding areas. This property's three bedrooms, modern design, and two dedicated parking spaces make it an ideal choice for young families or anyone looking to downsize to a cozy, convenient home.

Internally - Upon entering through the porch, you are greeted by a welcoming lounge that leads to an open-plan kitchen and dining area at the back—perfect for hosting friends and family. The dining area overlooks a well-proportioned garden, manageable for those who prefer a low-maintenance outdoor space. Upstairs, you'll find three generously sized bedrooms, two of which are doubles, with ample storage throughout. The master bedroom also includes an en-suite shower room, reducing any morning rush for the family bathroom.

Additionally, there is allocated parking, ensuring easy, stress-free parking without the hassle of competing with neighbours.

This property also benefits from nine years remaining on its NHBC warranty, offering added peace of mind.











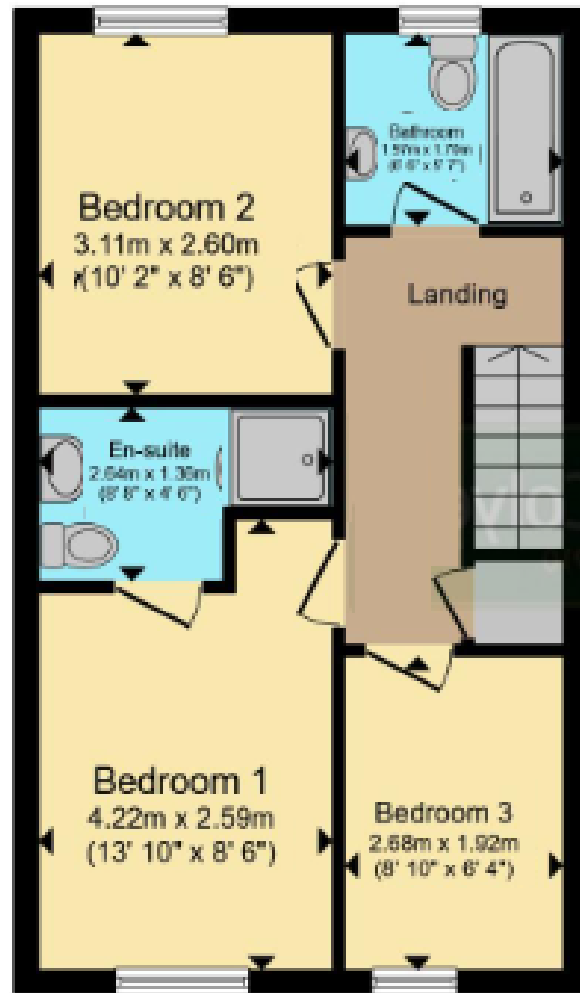

Ground Floor

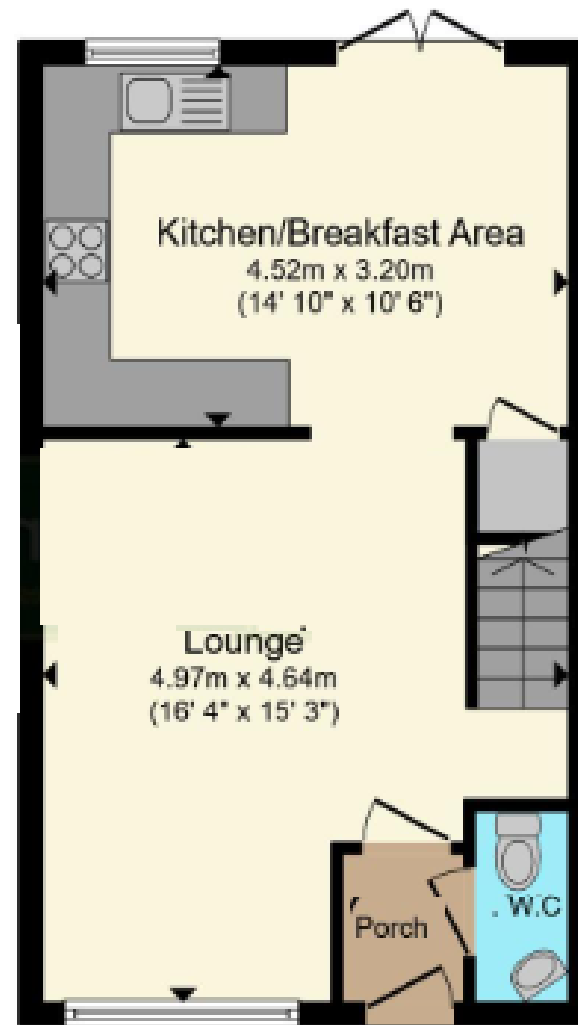

First Floor

Total floor area 76.7 sq.m. (826 sq.ft.) approx

This floorplan is for illustrative purposes only and is not drawn to scale. Measurements, floor-areas, openings and orientations are approximate. They should not be relied upon for any purpose and do not form any part of an agreement. No liability is taken for any error or mis-statement. All parties must rely on their own inspections.