



Cumberland Street, Latchford WA4

£127,500

🛏️ 2 🚿 1 🚗 0



******* NO CHAIN DELAY *******

A traditional two bedroom mid terrace property offering an ideal investment or first time buyer opportunity in a popular Latchford location.

Features briefly include; UPVC double glazing, gas fired 'combi' central heating, entrance porch, two reception rooms, kitchen, bathroom, two double bedrooms and a small yard to the rear.

Early Viewing Advised.

Viewing

By prior appointment through our Stockton Heath office on 01925-398343.

Note

All measurements are approximate. No appliances or central heating systems referred to within these particulars have been tested and therefore their working order cannot be verified. Floor plans are for guide purposes only and all dimensions are approximate and are not to be used for room and furniture planning.

Agents Notes

Tenure: Freehold

Council Tax Band: A

Local Authority: Warrington Borough Council

EPC Rating: tbc



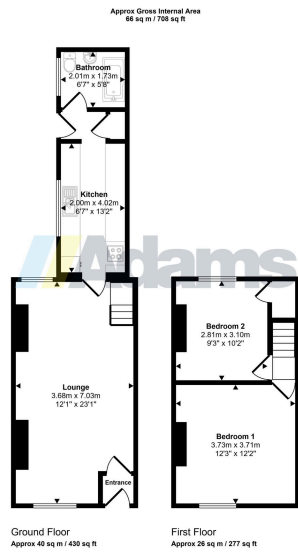

This floorplan is only for illustrative purposes and is not to scale. Measurements of rooms, doors, windows, and any items are approximate and no responsibility is taken for any errors, omissions or misstatements. Items of items such as bathroom suites are representations only and may not look like the real items. Made with Made Easy 360.

- Traditional Mid Terrace
- Two Double Bedrooms
- Gas Fired 'Combi' Central Heating
- No Chain Delay
- Popular Latchford Location
- Large Open Plan Living Area
- On Road Parking To Front

