



Derwent Close, Dronfield Woodhouse, S18 2FQ

£179,950

🛏️ 2 🪑 1 🚗 1



Why You'll Love It:

Situated in the heart of Derbyshire, this property offers more than just a beautiful home; it provides access to the stunning natural landscapes and charming communities that define this region. Dronfield Woodhouse, a highly desirable residential area, is surrounded by picturesque villages and towns such as Holmesfield, Coal Aston, and Unstone. The area is characterised by its rolling hills, scenic walking trails, and close-knit community spirit.

Dining Kitchen:

A generously proportioned kitchen with ample space for dining. The room features a modern range of wall and base units complemented by a durable work surface and a stainless-steel sink with a drainer. The kitchen is equipped with an integrated electric oven, a gas hob with an extractor hood, plumbing for a washing machine, and space for a fridge freezer. An additional understairs storage cupboard provides practical extra storage, ensuring your kitchen remains clutter-free and functional.

Lounge:

The neutrally decorated lounge offers a bright and inviting space, enhanced by uPVC double-glazed sliding patio doors that lead directly to the rear garden. This connection to the outdoor space allows for seamless indoor-outdoor living, perfect for enjoying the serene surroundings of the Derbyshire countryside.

First Floor Landing:

The first-floor landing provides access to the loft, which offers potential for additional storage or even expansion, subject to the necessary permissions. This flexibility allows you to adapt the space to suit your needs as they evolve.

Bedroom One:

A spacious and modern rear-facing double bedroom, featuring bespoke fitted wardrobes with double hanging rails and integrated drawers, providing ample storage and a stylish finish. The tranquil setting ensures restful nights, and the custom storage solutions maximize space and organization.



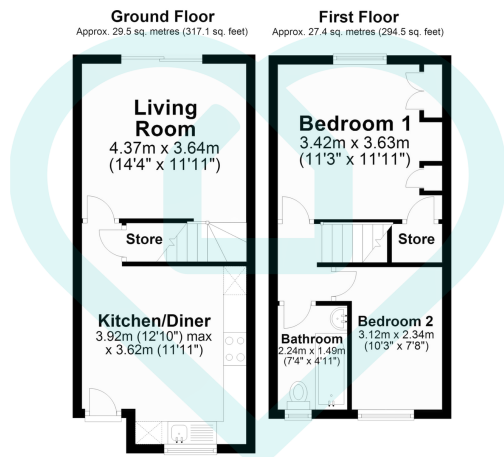

Total area: approx. 56.8 sq. metres (611.6 sq. feet)

This floor plan is for illustrative purposes only. All measurements and layouts are approximations and do not necessarily capture the precise specifications of the property. No responsibility is taken for any error, omission, or misstatement. We always recommend viewing in person to confirm the exact floor plan of a property. Made with Metropix.

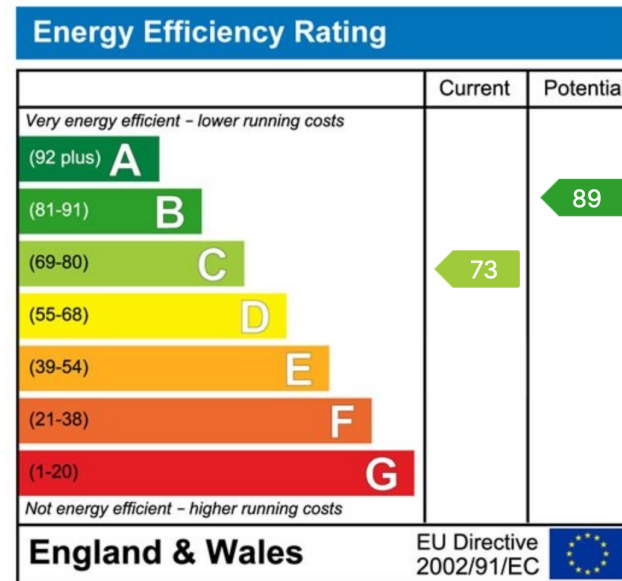

Sales | Lettings | New Homes

VAT Reg Number: 191 3588 84
Company Reg Number: 08610489
Company Reg Address: 67 Middlewood Road, Hillsborough, Sheffield, S6 4GX.

The MorfittSmith Building
67 Middlewood Road
Hillsborough
Sheffield
S6 4GX

Get in touch - arrange an appointment



0114 232 1764
sales@morfittsmith.co.uk
lettings@morfittsmith.co.uk
newhomes@morfittsmith.co.uk
www.morfittsmith.co.uk



@MorfittSmith
@MorfittSmith
MorfittSmith
Estate & Letting Agent