



Bank House, Langsett Road, Hillsborough, S6 2LN

From £145,000

🛏 1 🚿 1 🚪 1



Why We Love It

Nestled in vibrant Hillsborough, Bank House offers residents an array of independent shops, cafes, and parks just a stone's throw away. Whether it's a peaceful stroll in Hillsborough Park or a quick hop on the SuperTram to Sheffield City Centre, everything is at your doorstep. For drivers, Penistone Road (A61) offers easy access to Sheffield City Centre and the M1 motorway, while Langsett Road and Holme Lane provide convenient connections to surrounding areas. Plus, the Peak District is just a short drive away for those who enjoy outdoor escapes.

Why You'll Love It

Bank House is an exciting new development offering eight modern and thoughtfully designed one - and two-bedroom apartments. Situated in the heart of Hillsborough, this development perfectly blends modern urban convenience with the charm of a historic building.

The apartments offer open-plan living spaces filled with natural light, creating a bright and airy atmosphere. The kitchens are architect-designed, featuring high-specification integrated appliances and sleek quartz worktops, adding a touch of luxury. Each room has been thoughtfully crafted to provide a perfect balance of style and functionality, making these homes truly special.

The sleek wooden floors flow throughout each apartment, enhancing the sense of space and elegance. In addition, the properties include luxurious bathrooms, ensuring every detail is finished to a high standard. With energy-efficient features like Wi-Fi-enabled heating panels and double-glazed windows, Bank House is designed for both comfort and sustainability. Select apartments even offer scenic views of the River Loxley, adding to the tranquillity of this unique living experience.



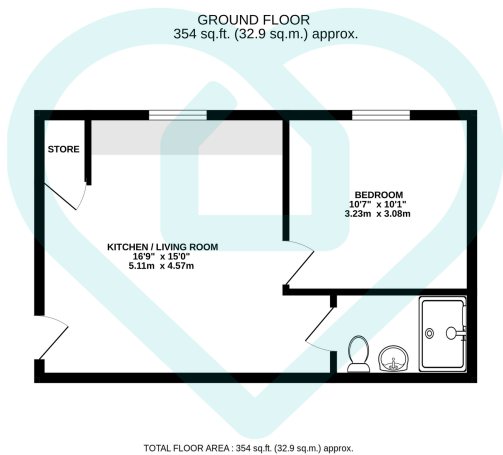

This floor plan is for illustrative purposes only. All measurements and layouts are approximations and do not necessarily capture the precise specifications of the property. No responsibility is taken for any error, omission, or misstatement. We always recommend viewing in person to confirm the exact floor plan of a property. Made with Metropix.



- From £144,000 - £170,000
- Open-Plan Living Spaces
- Large Picture Windows for Natural Light
- Wooden Floors Throughout
- Secure Entry System
- Proximity to Hillsborough Park and Local Shops
- Architect-Designed Kitchens
- Double-Glazed Windows
- High Quality Bathroom fittings
- Fantastic Public Transport Links

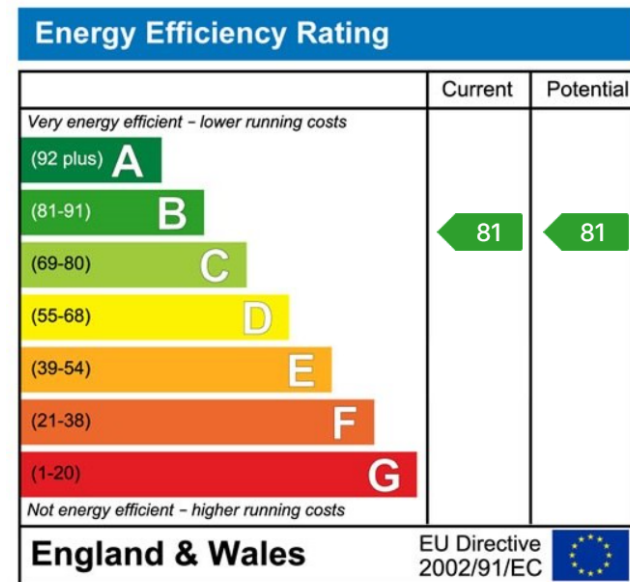

Sales | Lettings | New Homes

VAT Reg Number: 191 3588 84
Company Reg Number: 08610489
Company Reg Address: 67 Middlewood Road, Hillsborough, Sheffield, S6 4GX.

The MorfittSmith Building
67 Middlewood Road
Hillsborough
Sheffield
S6 4GX

Get in touch - arrange an appointment



0114 232 1764
sales@morfittsmith.co.uk
lettings@morfittsmith.co.uk
newhomes@morfittsmith.co.uk
www.morfittsmith.co.uk



@MorfittSmith
@MorfittSmith
MorfittSmith
Estate & Letting Agent