

Vinery Meadow, Penryn

Guide Price £320,000

3 1 1



A superb end of terrace, three bedroom home enjoying an elevated position with views over Penryn to surrounding countryside. Immaculately presented throughout, contemporary open plan living, benefitting from a GCH system (via underfloor heating & radiators) and solar panels.

Key Features

- Modern end of terrace home
- Contemporary open plan living
- Fully fitted kitchen
- Allocated off road parking
- Southwest facing courtyard style garden
- Three bedroom accommodation
- Lounge/dining room with feature fireplace
- Family bathroom, additional GF WC/utility
- UPVC double glazing, GCH, solar panels
- Elevated town & countryside views

GROUND FLOOR
434 sq.ft. (40.3 sq.m.) approx.

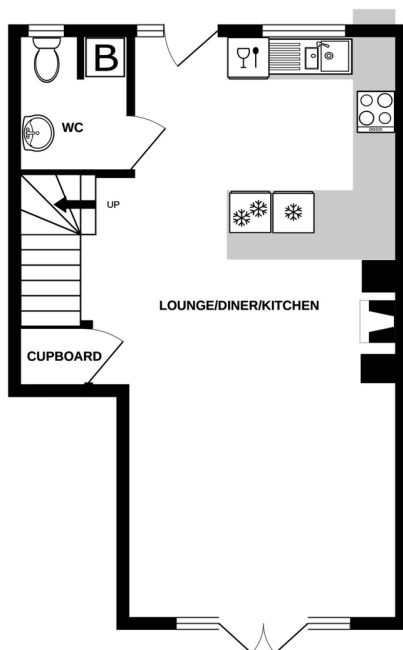

1ST FLOOR
442 sq.ft. (41.1 sq.m.) approx.

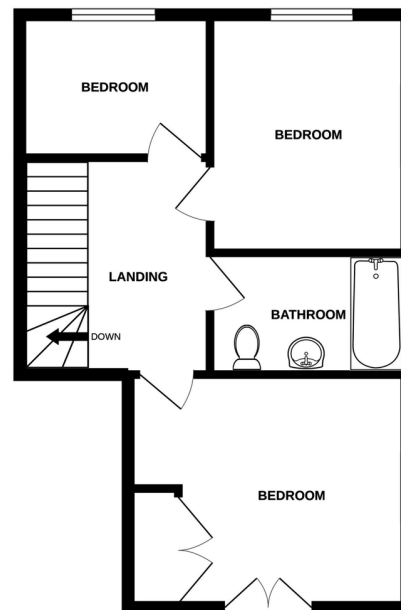

TOTAL FLOOR AREA : 875 sq.ft. (81.3 sq.m.) approx.

Whilst every attempt has been made to ensure the accuracy of the floorplan contained here, measurements of doors, windows, rooms and any other items are approximate and no responsibility is taken for any error, omission or mis-statement. This plan is for illustrative purposes only and should be used as such by any prospective purchaser. The services, systems and appliances shown have not been tested and no guarantee as to their operability or efficiency can be given.
Made with Metropix ©2022