



Hurworth Springs Country Park Neasham Road, Hurworth Moor

£220,000

🛏️ 2 🚿 2 🛋️ 1



- Detached Park Home Bungalow
- Two Double Bedrooms
- Impressive Kitchen with Utility
- Ensuite and Guest Bathroom
- CASH BUYERS ONLY
- 54'x22' Delamere Design
- Spacious Accommodation
- Living Room Measuring Over 21ft
- Gated Residential Park
- Gardens and Off Street Parking



A stunning, spacious two double bedroom park home bungalow (54'x22') located in a prominent position on this gated residential park for the over 45's. This 'Delamere' home offers a luxurious yet spacious feel throughout which many buyers will be impressed with and the home boasts a separate entrance hall, an impressive kitchen/dining room with utility room, light and airy living room, two double bedrooms with the master having an ensuite shower and walk-in wardrobe, a further guest bathroom as well as decked areas to two sides of the home, gardens to all sides and off street parking for 2/3 cars. This home should be viewed without delay!

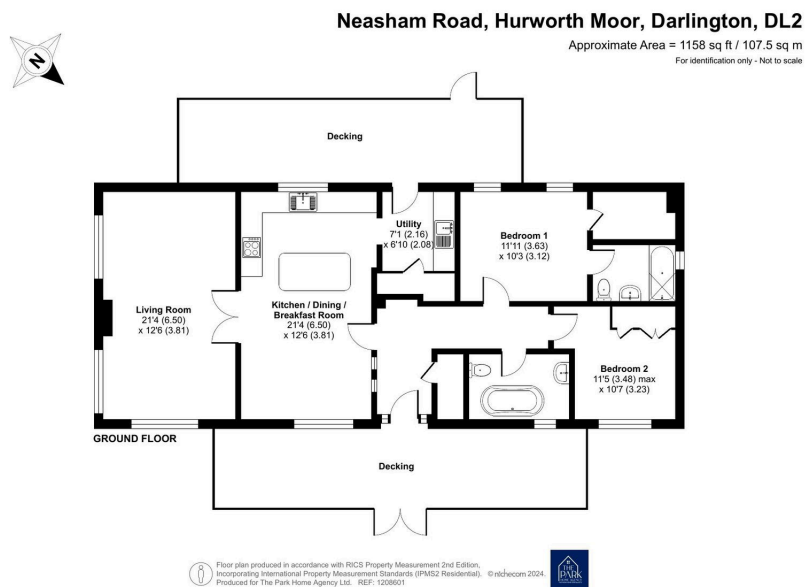

01793 230185
 sales@theparkhomeagency.co.uk

Agents Notes: All measurements are approximate and quoted in metric with imperial equivalents and for general guidance only and whilst every attempt has been made to ensure accuracy, they must not be relied on. The fixtures, fittings and appliances referred to have not been tested and therefore no guarantee can be given that they are in working order. Internal photographs are reproduced for general information and it must not be inferred that any item shown is included with the property. For a free valuation, contact the numbers listed on the brochure