



Cosford Park, Albrighton, Wolverhampton, West Midlands, WV7

£125,000

🛏️ 2 🚿 2 🛋️ 1



- Detached Park Home Bungalow
- Garden and Driveway
- Double Glazing
- End Of Chain Sale
- Spacious Accommodation
- Two Double Bedrooms
- Popular Residential Park
- Gas Central Heating
- CASH BUYERS ONLY
- En-Suite To Bedroom 1



PRICED FOR A QUICK SALE...A well presented and spacious park home bungalow located on this sought after and conveniently located residential parks for the over 55's. This two double bedroom home offers a layout that will impress many buyers and internally the home boasts a separate entrance hall, a spacious lounge, dining area, a modern fitted kitchen with a utility room, a master bedroom with an ensuite and walk-in wardrobe, a second double bedroom with built in wardrobes, a further guest bathroom as well as double glazing and gas central heating. To the exterior, there are gardens to all sides of the home with a rear garden with mature hedging, is mainly laid to lawn and there is a driveway to the side of the home.

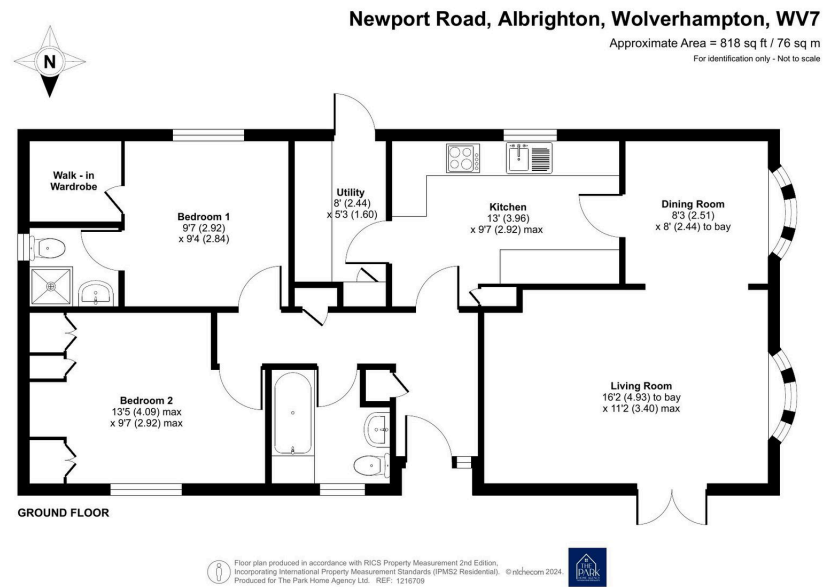

01793 230185
 sales@theparkhomeagency.co.uk

Agents Notes: All measurements are approximate and quoted in metric with imperial equivalents and for general guidance only and whilst every attempt has been made to ensure accuracy, they must not be relied on. The fixtures, fittings and appliances referred to have not been tested and therefore no guarantee can be given that they are in working order. Internal photographs are reproduced for general information and it must not be inferred that any item shown is included with the property. For a free valuation, contact the numbers listed on the brochure