

Boconnoc Avenue, Callington, PL17 7TW

Guide Price £225,000

3 2 1



NO ONWARD CHAIN! Nestled in a quiet cul-de-sac location, this delightful 3-bedroom semi-detached home offers the perfect blend of comfort and convenience. Step inside and be greeted by a warm and inviting atmosphere, with a modern fitted kitchen and spacious lounge/diner boasting large patio doors that floods the space with natural light. Upstairs, you'll find three well-proportioned bedrooms, including a fabulous en-suite shower room and modern family bathroom. Outside, the private rear garden is a true gem, offering a secluded oasis for alfresco dining or entertaining. Other highlights include a single garage, off-road parking and a handy downstairs wc.

Key Features

- Freehold - EPC TBC - Council Tax Band C
- Off-Road Parking & Single Garage
- Lounge/Diner
- Family Bathroom
- Downstairs WC
- Semi-Detached Home
- Three Bedrooms & En-Suite Shower Room
- Modern Kitchen
- Generously Sized Enclosed Rear Garden
- No Onward Chain - Quote BH0675 To Book Your Viewing

Ground Floor

Approx. 23.1 sq. metres (248.9 sq. feet)

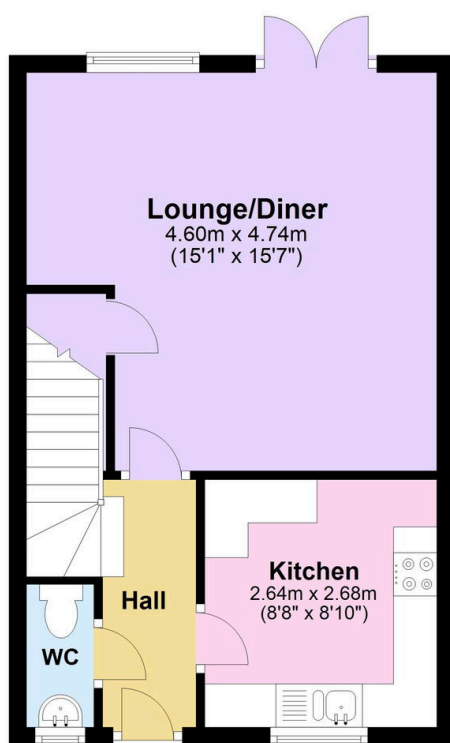

First Floor

Approx. 35.7 sq. metres (384.7 sq. feet)

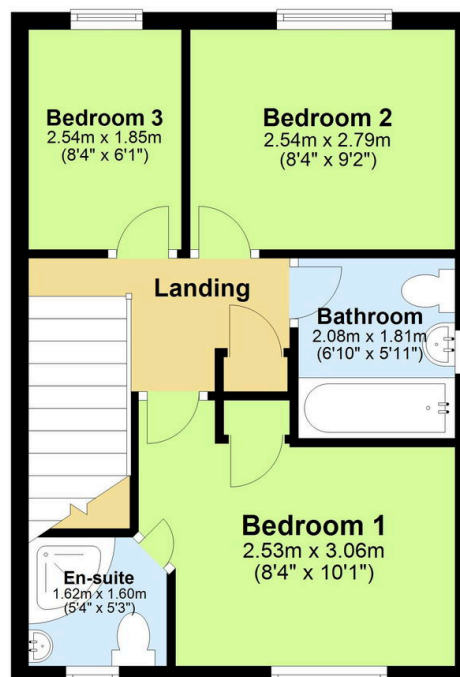

Total area: approx. 58.9 sq. metres (633.6 sq. feet)