

Kirkby Close, Rugby, CV21 1TT

Offers Over £375,000

3 3 2



This beautiful three bedroom detached property on the outskirts of Rugby, Warwickshire. 1173 sq ft of accommodation. one not to be missed.

A perfect family home, combining modern comforts with a prime location. Nestled in a quiet cul-de-sac to the north of this historic and popular town, the property is ideally positioned for commuters and families alike.

Open House coming soon (please contact the agent)

LO 0765

Key Features

- Newly fitted Kitchen and appliances
- Prime location near footpaths and fields
- Separate office / salon for work from home business
- Double glazed
- Off Road private parking
- New gas combi Boiler
- Bright and airy Lounge/dining
- Three good sized bedrooms
- Conservatory and downstairs cloakroom
- Hot Tub included - 3 years old and serviced regularly

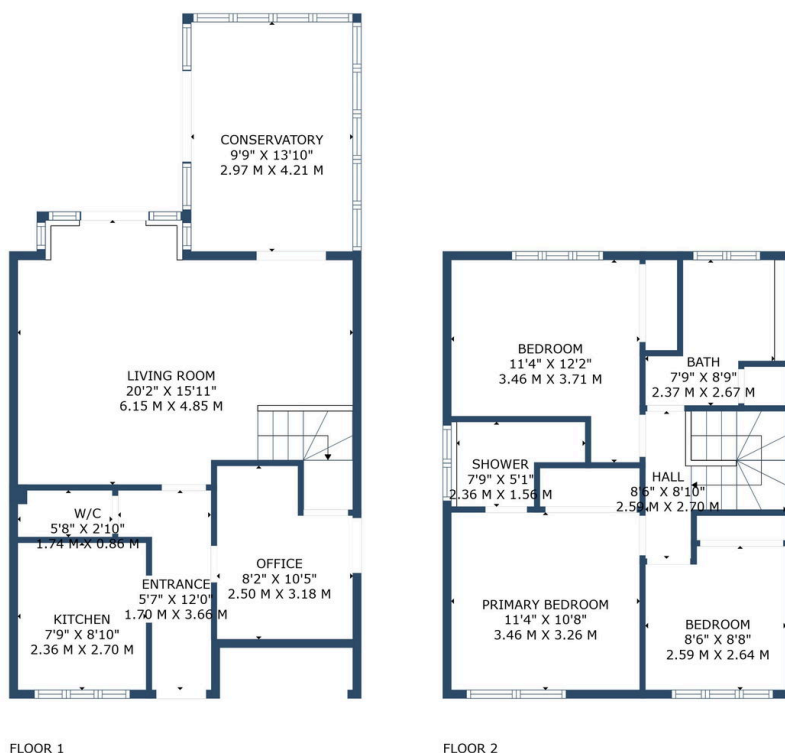

TOTAL: 1173 sq. ft, 109 m2
 FLOOR 1: 650 sq. ft, 60 m2, FLOOR 2: 523 sq. ft, 49 m2
 EXCLUDED AREAS: " " : 104 sq. ft, 10 m2

Floor Plan Created By Harper & Reid. Measurements Deemed Highly Reliable But Not Guaranteed