

# DAVID CHARLES

ESTATE AGENTS • VALUERS • SURVEYORS  
THE ESTATE OFFICE • 34 HIGH STREET • PINNER • MIDDLESEX HA5 5PN  
TELEPHONE 020 8866 0222 • FAX 020 8868 3544  
WEBSITE [www.david-charles.co.uk](http://www.david-charles.co.uk) • E-MAIL [enquiries@david-charles.co.uk](mailto:enquiries@david-charles.co.uk)

## CRAIGMORE COURT, MURRAY ROAD, NORTHWOOD, HA6 2YQ



**PRICE...£1,650 PCM**

This well presented two double bedroom ground floor maisonette (663 sq.ft/61 sq.m) is located in the heart of Northwood se back from Murray Road within easy reach of Northwood Metropolitan Line Tube Station, local shops, coffee house, restaurants and Waitrose Supermarket. The accommodation comprises of own front door leading to entrance hall, 20'6ft reception/dining room, modern fitted kitchen, two double bedrooms and modern shower room and WC. Outside the property benefits from well maintained communal gardens, resident and visitor parking and garage. Unfurnished. Available from 8th December (Subject to References).

**020 8866 0222**







## COUNCIL TAX

London Borough of Hillingdon - Band E - £2,278.09

## LOCAL SCHOOLS

Frithwood Primary School - 0.8 Miles  
Holy Trinity C of E Primary School - 0.8 Miles  
St Helen's School - 0.4 Miles  
Northwood School - 1.0 Miles

## LOCAL TRANSPORT

Northwood Station (Metropolitan Line) - 0.4 Miles  
Northwood Hills Station (Metropolitan Line) - 1.1 Miles

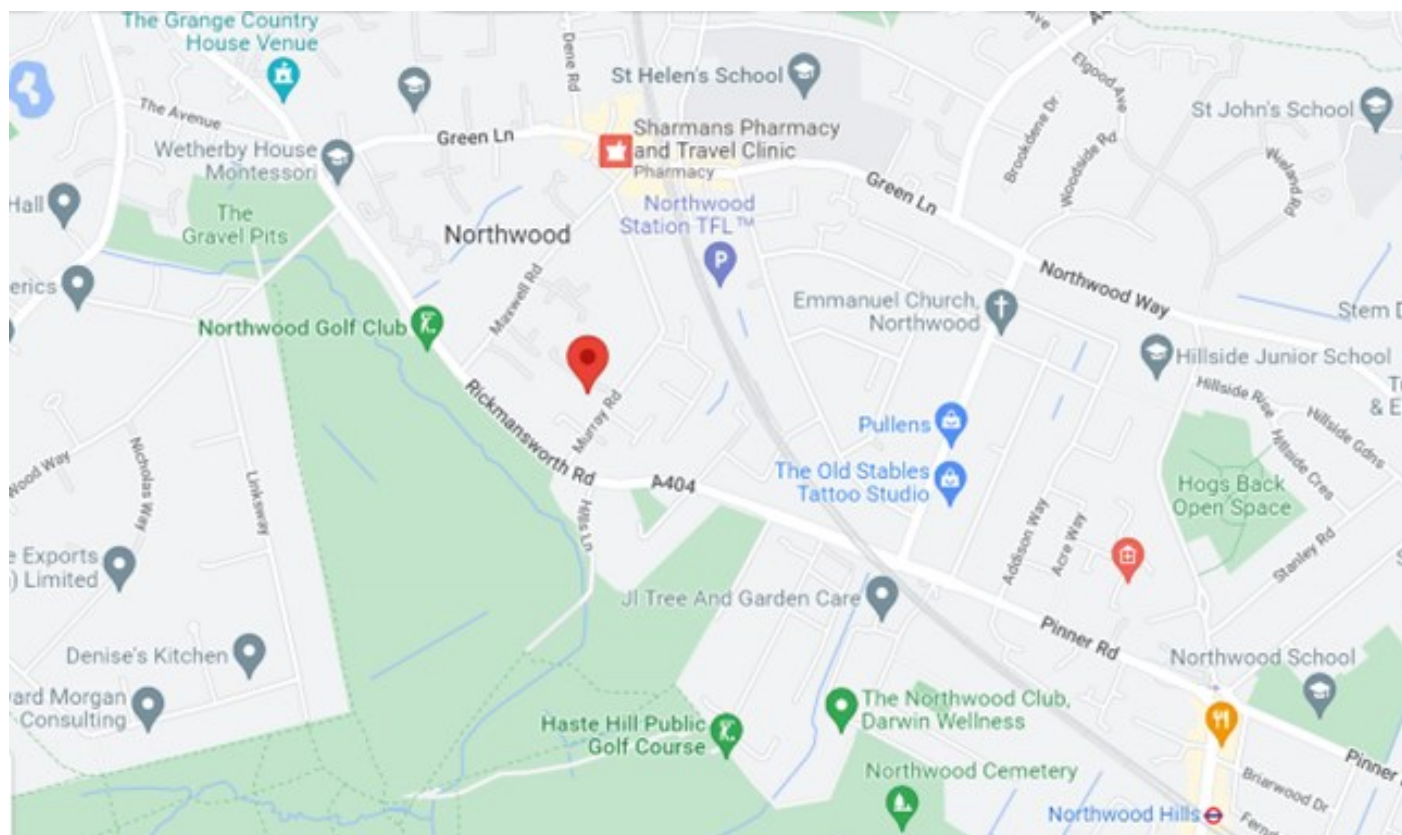

Energy Efficiency Rating		Current	Potential
Very energy efficient - lower running costs			
(92-100) <b>A</b>			
(81-91) <b>B</b>			
(69-80) <b>C</b>			
(55-68) <b>D</b>		71	77
(39-54) <b>E</b>			
(21-38) <b>F</b>			
(1-20) <b>G</b>			
Not energy efficient - higher running costs			
England, Scotland & Wales		EU Directive 2002/91/EC	

# Craigmore Court

Approximate Gross Internal Area = 61.5 sq m / 663 sq ft



= Reduced headroom below 1.5m / 5'0

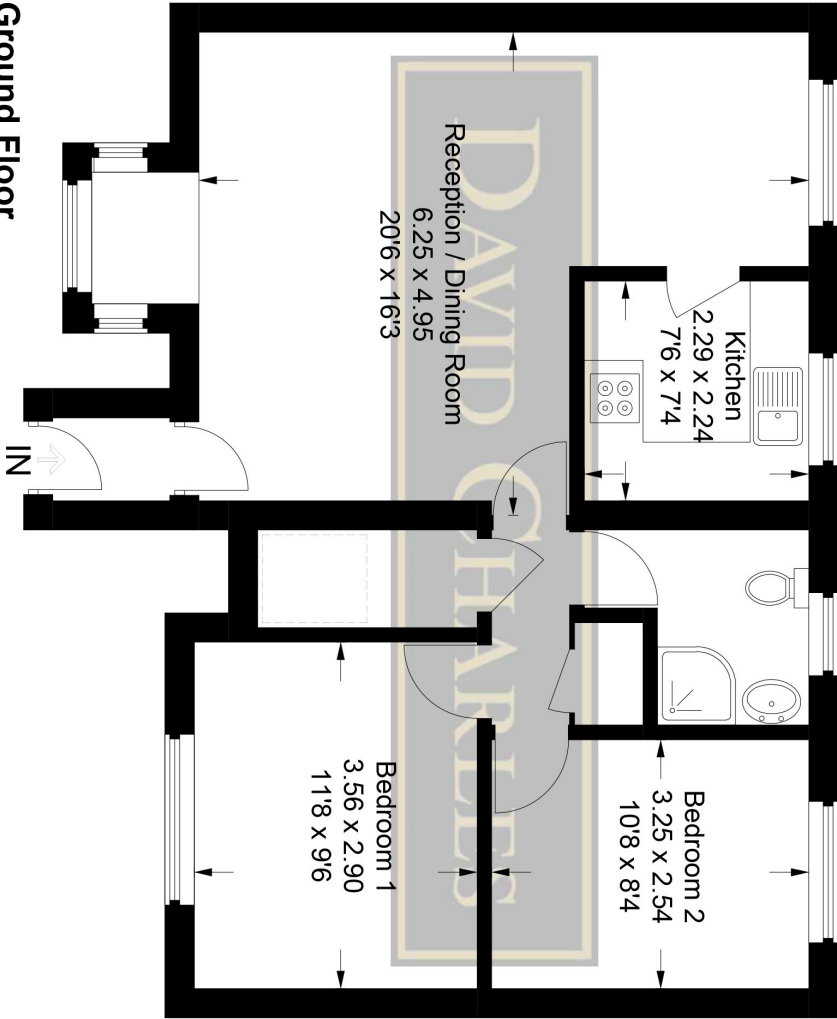

## Ground Floor

This plan is for layout guidance only. Not drawn to scale unless stated. Windows and door openings are approximate. Whilst every care is taken in the preparation of this plan, please check all dimensions, shapes and compass bearings before making any decisions reliant upon them.  
© CJ Property Marketing Ltd Produced for David Charles



***For appointments to view please call David Charles 020 8866 0222***

*All measurements are taken manually and whilst every care is taken with their accuracy they must be considered approximate and should not be relied upon when purchasing carpets or furniture. No responsibility is taken for any error, omission or misunderstanding in these particulars which do not constitute an offer or contract. Services and appliances have not been tested and therefore no warranty is offered on their operational condition.*